

kettal

Index

Kettal

Officescape

A collection

Eolias collection

Sofa O

Kall

Pavilion O

Focus

Meeting rooms

Hub

Lighting

Specifications

Materials

Sustainability

Credits

Furniture

Focus

High focus / Workpoints

A collection by
Naoto Fukasawa
Page 14-31

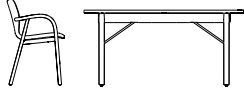

Eolias collection
by Antonio Citterio
Page 32-45

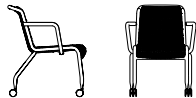

Sofa O
by Kettal Studio
Page 46-51

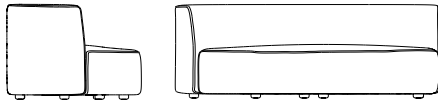

High focus / Workpoints

Kall S
Page 52-63

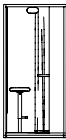

Kall M
Page 52-63

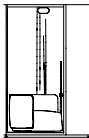

Phone booth S
(1 person)
Page 72-83

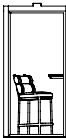

Phone booth L
(2 persons)
Page 72-83

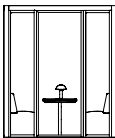

Phone booth XL
(4 persons)
Page 72-83

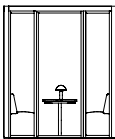

Meeting&Hub

Support

Formal collaboration/Flexible/Informal/Collaborative

Meeting rooms
2-8 persons
Page 86-107

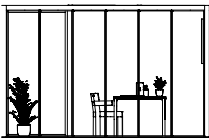

Hub
Curved
Page 108-135

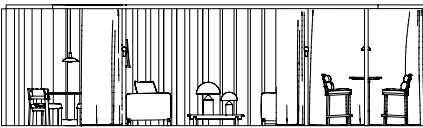

Hub
Walk-Through
Page 108-135

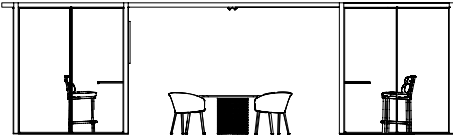

Hub Open
With meeting
& Sofas
Page 108-135

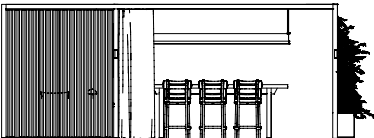

Hub Open
With Curtains
Page 108-135

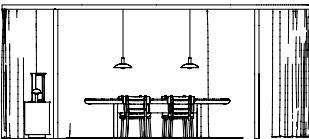

Hub Open
Page 108-135

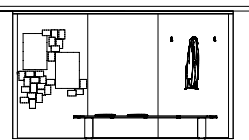

Hub
Outdoor
Page 108-135

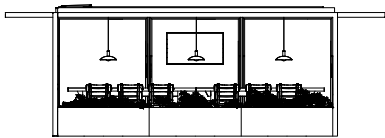

Business/People support

Reception
Page 136-155

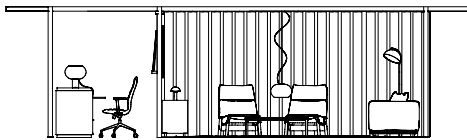

Reception
With Meeting
& Printing Area
Page 136-155

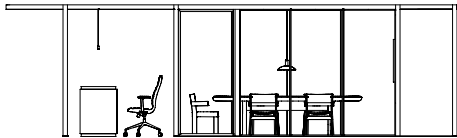

Lockers
Page 136-155

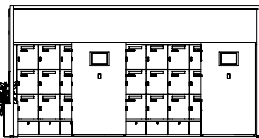

Kitchen
Page 136-155

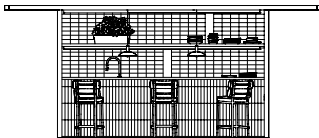

Kettal is a family business established in Europe in 1966.



All of our products are manufactured 45km from Barcelona in a small coastal town. We pride ourselves on our European made quality. In-house manufacturing allows us to pay close attention to detail and gives us the ability to meet our clients' customization requirements, making each piece of Kettal furniture unique and exclusive.

The importance of research – both scientific and technological – has always been at the forefront of our product development. The high-quality products we offer today are the result of our spirit of innovation.

We have our own state of the art manufacturing plant where the product is designed, manufactured and tested locally.

Our manufacturing processes involve intense manual labor and 85% of Kettal products are handmade. Our handmade ethos means that we build strong yet beautiful Kettal pieces that display an exquisite attention to detail.

Officespace

The need for flexible, open-plan workspaces is clear. Pavilion O allows you to define your own layouts in a way that meets both the demands of modern employees and the unique needs of your company. As if you were the architect of your own city, you can use Pavilion O to help you define your workplace’s structure, private and public spaces, and overall flow.

A workplace resembling a living city, with its interconnected neighborhoods, networks & spaces.

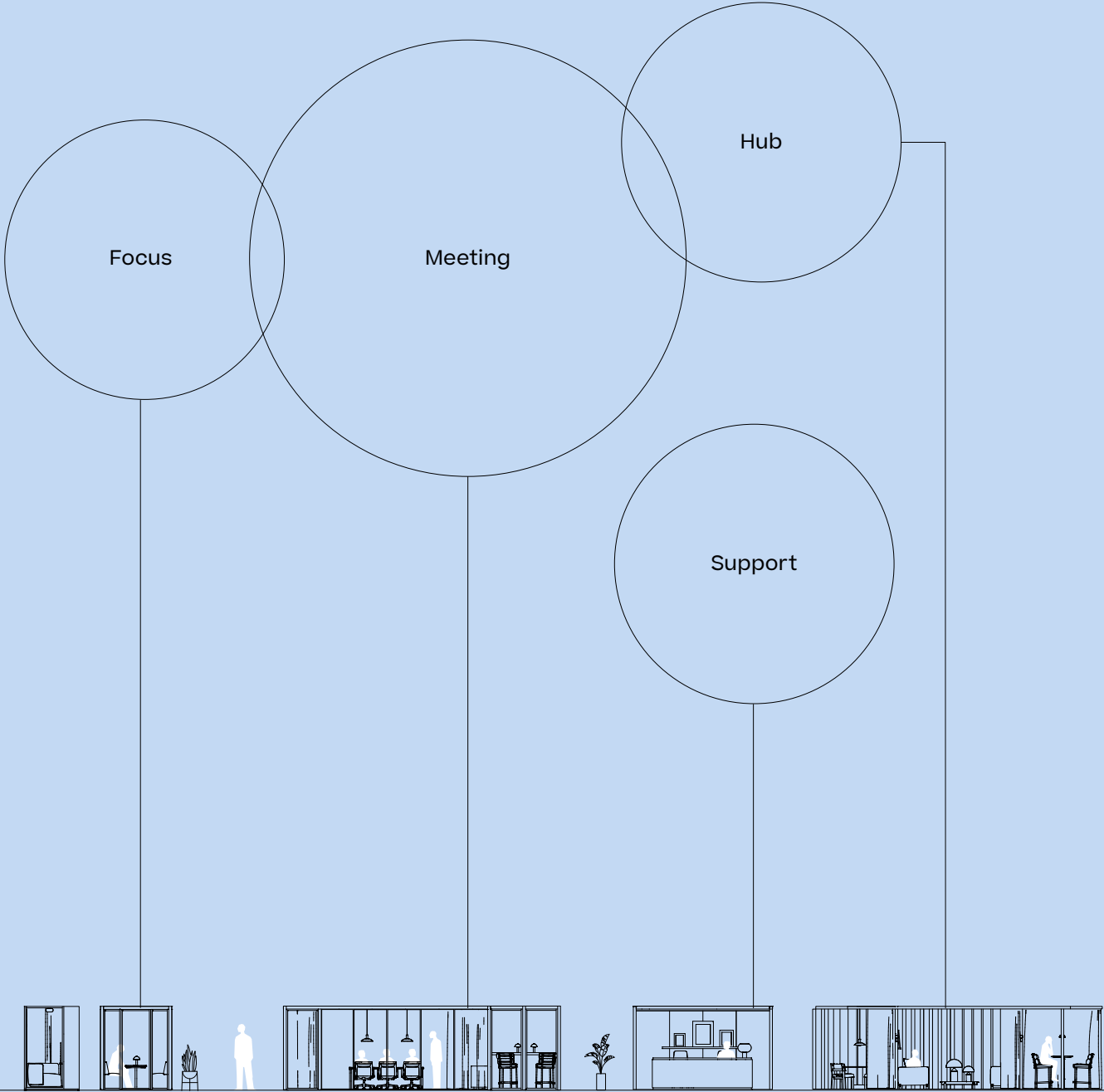

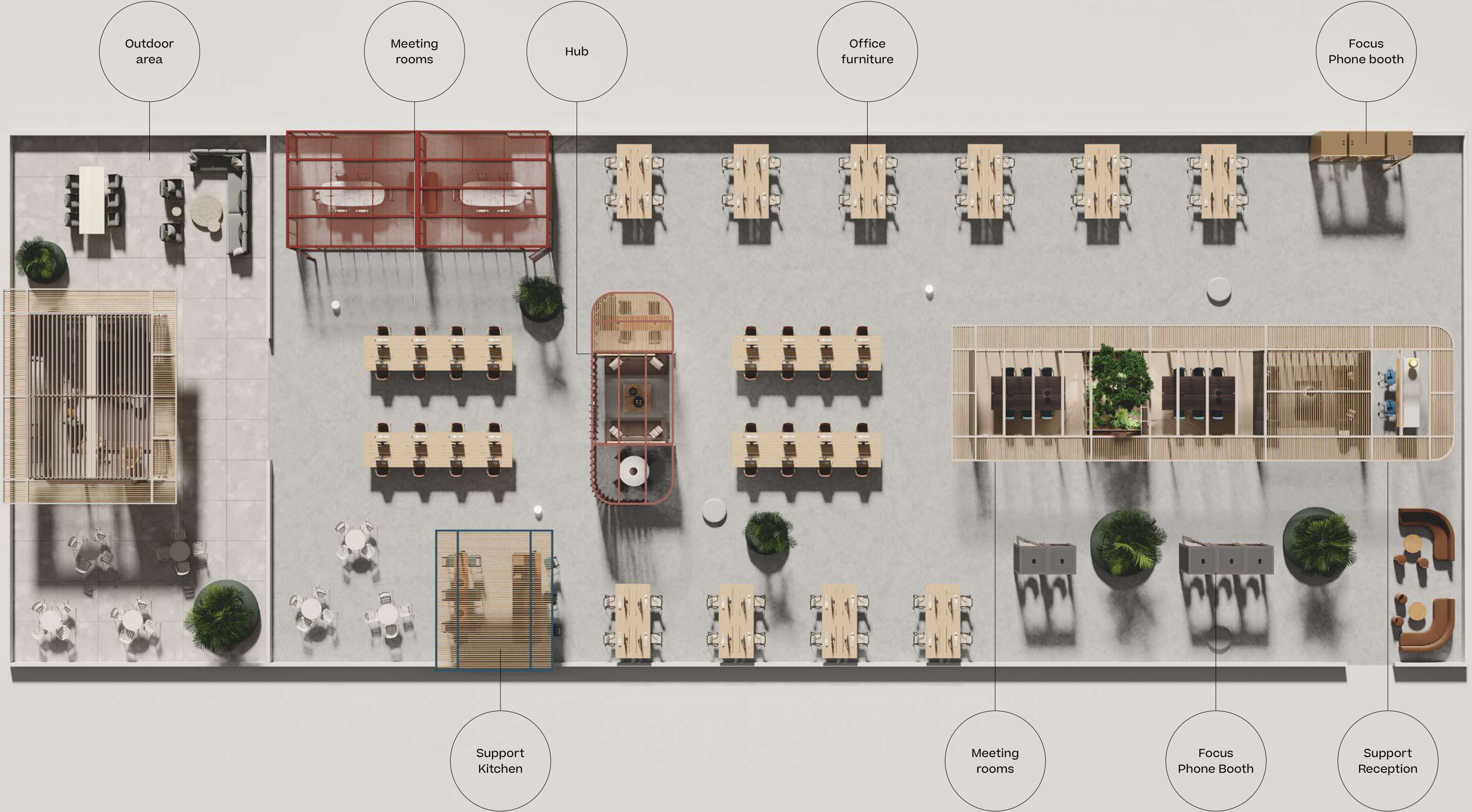

New products

Discover our new products.
Our wide range of durable collections allow you to create work environments and public spaces that are suitable for a wide variety of uses, both for individuals and for teams. We also design products for areas where people can work in silence and with complete concentration.

The furniture collection, which is suitable for both indoors and outdoors, is lively and expressive. It features modern classic designs, with an informal and stimulating language, enriched by contemporary colors and materials.

Elevate your workspace.
Elevate your life. Discover our new collections, where office meets home, and style meets productivity.

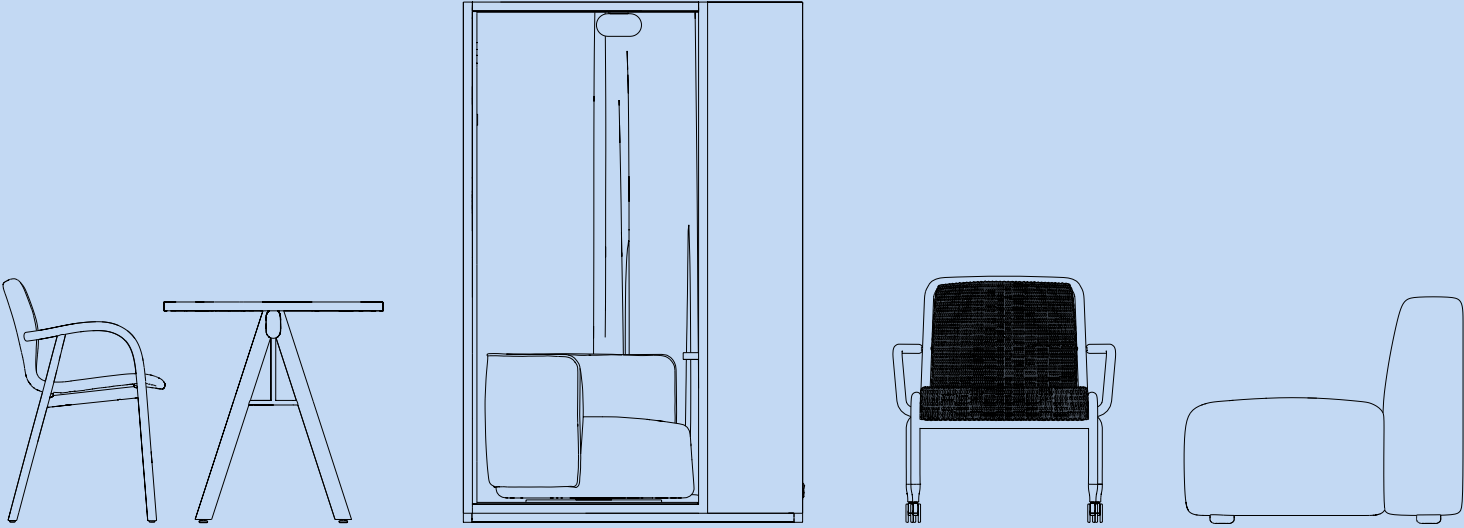

A, by Naoto Fukasawa

Chairs and desks made of solid wood are not very common in the office environment. The concept of working places integrating home and office made a change, and I think it became more like that. The touch of our hands and bodies with the wood means coexisting with trees and getting closer to nature. It means living together. Wooden round bars do not cast strong line shadows in the space. It is beautiful and warm, in harmony with air, light, and people.



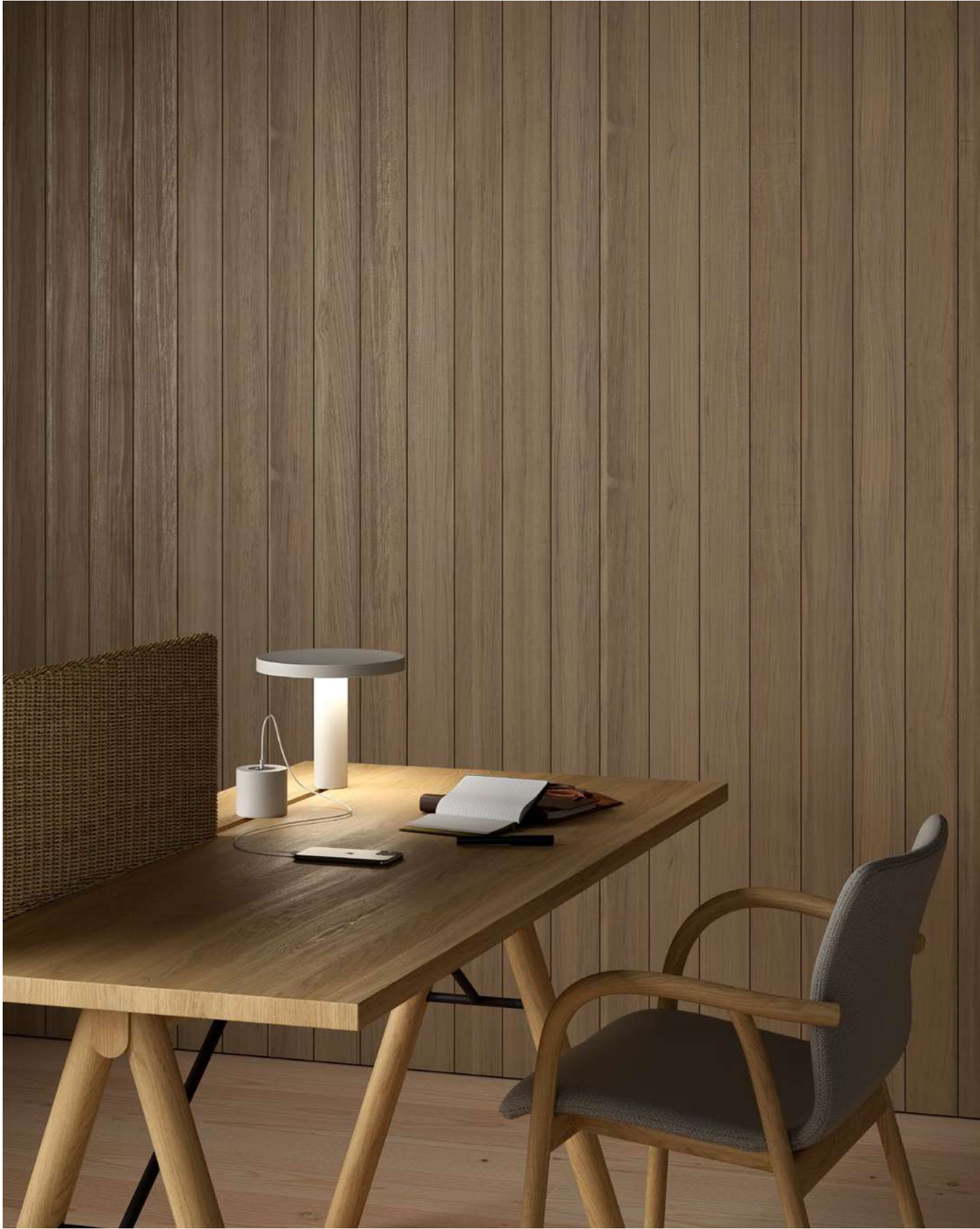



A









Accessories A system

Lamp

Add a touch of style and functionality to your System A desk with our sleek ceramic lamp. This versatile lamp can be easily moved from side to side, providing customizable lighting to meet your needs. The dimmable feature allows you to adjust the brightness to your liking, while the ceramic material gives it a modern and sophisticated look. In addition, the lamp features a convenient tray for storing small desk accessories like clips and other items. Available in both black and white, this elegant lamp is the perfect addition to any workspace.

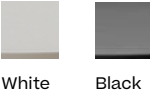

Color temperature: 2700K, 3 step.
CRI: >90
Lumen maintenance:
L70 48.000 hours
(0% of initial light output
maintained)
IP20

Screen

Wicker desk dividers, available in both frontal and lateral designs. Made from high-quality wicker material, these dividers are perfect for creating organized workspaces and reducing distractions. Available in both natural and dark colors, our wicker desk dividers add a touch of elegance to A desk while also providing practical benefits. Whether you need to create private workspaces, organize your desk, or simply add a touch of style, our wicker desk dividers are the perfect solution.



Power and USB connectivity

Moving sockets for the A desk system, available in both plug and USB A/C versions. These versatile sockets provide easy access to power and charging options while maintaining a sleek and organized workspace. Upgrade your desk with our functional and stylish lateral moving sockets today.

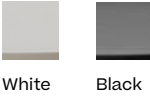





Chair

KSA000100

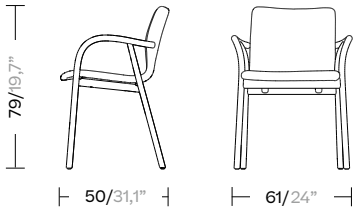

Home Deck

KSA000200

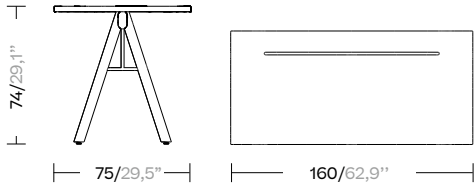

Meeting table

KSA000300

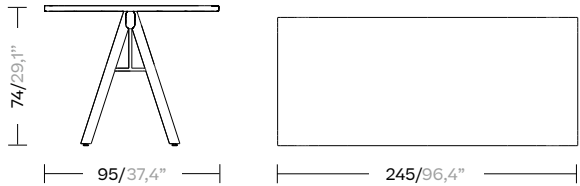

Eolias, by Antonio Citterio

Eolias Collection by Antonio Citterio, inspired by the breathtaking archipelago located off the coast of Sicily. This versatile collection includes a range of indoor and outdoor furniture pieces designed to elevate any space.

One of the collection's highlights is the Eolias Salinas series, which features a chair, club chair, and club lounge chair made from sturdy aluminum with a woven wicker detail. These pieces come in both indoor and outdoor versions, with the indoor chairs available with or without wheels for added convenience.





Workplace



Eolias











Eolias Salinas
Dining Armchair

KSB200100
KSB200200 with wheels

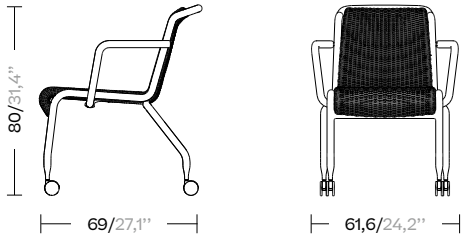

Eolias Salinas
Club Armchair

KSB200300
KSB200400 with wheels

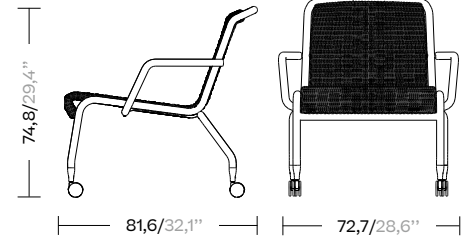

Eolias Salina
Lounge Club

KSB200900

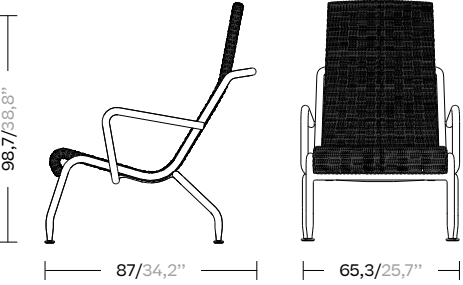

O Sofa, by Kettal Studio

In the dynamic world of offices and public spaces, blending function and aesthetics is vital. Offices require design that encourages collaboration, innovation, and well-being. Imagine the transformative influence of the Sofa O collection—a blend of modular straight and curved sofas along with a swiveling club chair—gracing these spaces. These innovative pieces bring versatility and adaptability, mirroring the flexibility needed in modern workspaces and communal areas.

Just as the Sofa O collection seamlessly connects its modules, offices embrace adaptable layouts for diverse workstyles, fostering teamwork. Similarly, public spaces emphasize multifunctionality, accommodating various events. In essence, these spaces harmonize productivity and leisure, bridging our professional aspirations and community bonds with the elegant and functional design of the Sofa O collection.







Swivel club O

KSB300600

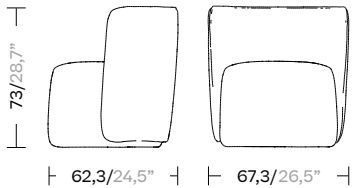

Left / Right Sofa O

Left
A2439DER0L L Size
A2439DER0XL XL Size

Right
A2439IZQ0L L Size
A2439IZQ0XL XL Size

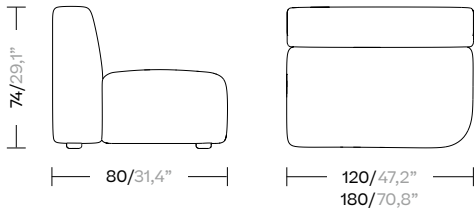

Central Sofa O

A2439TO10 L Size
A2439TOXL XL Size

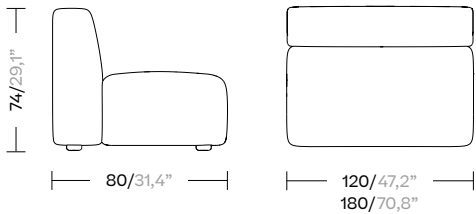

Left / Right Curved sofa O

Left
A2039IZQ00

Right
A2039DER00

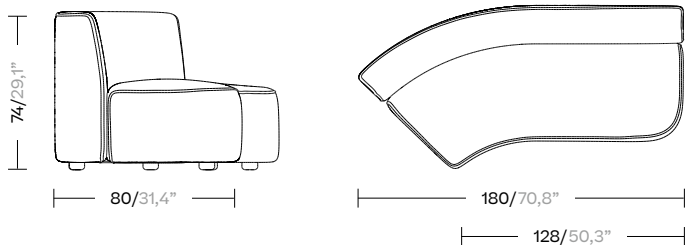

Kall, by Kettal studio

Part of our Focus system (page 72)

Introducing the Kall Collection - A modern solution for private and comfortable conversations. We believe that a Phone booth should simply be the door of a meeting room, which is why we have made the glass door the protagonist, and the space of the “Phone booth” corresponds to the projection of this door, making it appear embedded against the wall when viewed frontally. Our design ensures minimalism and functionality without any unnecessary frills.

Privacy is a key aspect, and we understand that users need a discreet environment for confidential meetings. Our small side walls provide structural support while also maintaining privacy for documents, device screens, and even facial expressions during a conversation. The addition of a translucent curtain further enhances the sense of protection against prying eyes.

We understand that a Phone booth should not be a cold space, so we have created a warm and inviting environment. Our design provides a pleasant atmosphere, making it closer to a meeting room or a home room rather than a typical elevator cabin.

Technology is an essential component, and we have ensured that the technology is intuitive and user-friendly. Everything is controlled electronically, with scene creation systems, table height regulation, ventilation control, and connectivity all intentionally hidden. Our interaction controls simulate the controls of old HIFI equipment, emphasizing that this booth is a simple and pleasant space where users can provide the main technology using their own devices. For tech-savvy users, we also offer a touchscreen control system.

The Kall Phone booth family consists of various sizes. The “S” is the basic and standard size. The “M” is 30cm wider, allowing for a swivel armchair, similar to a lounge room, with a relaxed work posture. We also offer an “L” version for two people and a “XL” for 4. All of our Phone booths are modular, which means they can be combined to create special configurations according to the situation.











Kall S

KSB300100

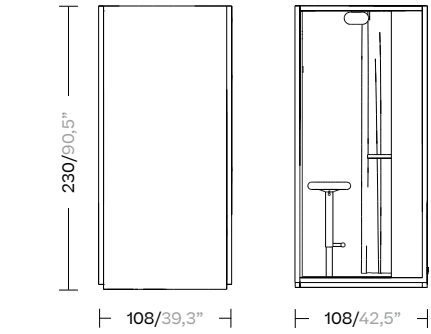

Kall M

KSB300200

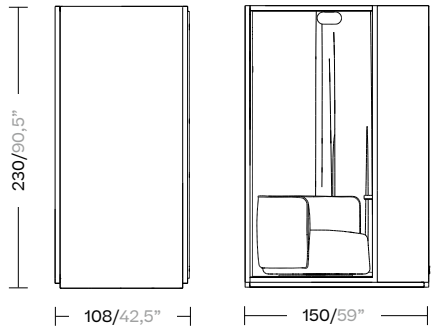

LED Lighting with PIR sensor & regulable

Wheels for an easy transport

Leveling feet

Sustainably Soundproof

Adjustable desk
1200mm
1000mm
700mm

Integrated swivel armchair

Silent ventilation system

Plug & Play 100-240 V + USB A + USB C

More accessories: Shelf, hanger...

PIR sensor

Fast Assembly

Modularity

Side panels

Soft Beige
LW1

Soft Cream
LW2

Light Brown
LW3

Light Oak
CW1

Dark Oak
CW2



See the video here



Kall Features

Silent Ventilation



The air enters through the floor (back of the stool) and comes out through the gap of each side of the table panel (1 cm of space) that is used to raise and lower the table. The cabin has a flow rate of 115m³/h (32 l/s) 60 air changes/hour inside. The nominal flow rate of the fans is 120m³/h.

Integrated wheels and Leveling feet

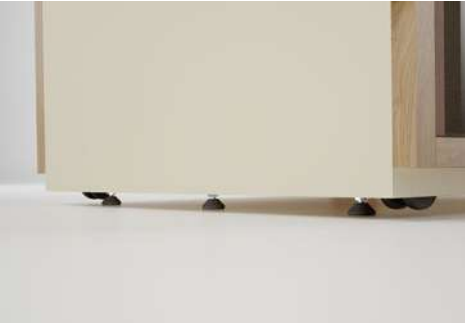

To ensure the stability of the cabin, the position of the regulator feet should be adjusted to raise the wheels. This procedure can be performed using a wrench, as the regulator feet have a nut that allows for adjustment. To move the cabin it is necessary to raise the regulator feet again.

Sustainably Soundproof



Class B, according ISO 23351-1
Test: 28,9 dB (D_{SA})
Acoustic glass panels 3+3 with 35 dB.
Wood panel + PET + Foamed fabric.

Test Report



Adjustable Stool (S)



- Adjustable via lever located under the seat.
- Adjustable from 550 to 800 mm.
- It supports a maximum weight of 200 kg.

Swivel armchair (M)



This versatile piece of furniture provides a comfortable and stylish seating option that can be easily adjusted to face any direction. With its sleek design and smooth rotation, the Swivel Armchair is ideal for comfortable meetings.

Shelf



To support your iPad, mobile phone, or complete the space with a picture or different decorative elements.

LED Ceiling Light



- LED Ceiling Light
- 3000K (Dimmable)
- Ambient Lighting

LED Shelf Light



- LED Shelf Light
- 3000K (Dimmable)
- Task Lighting

Adjustable Desk



The table height is adjustable by the cylindrical switch on the controller. It can be adjusted from 700 to 1200 mm in height. When non-adjustable height is 1100mm. It supports a maximum weight of 100 kg.

Controller



Adjustable table version. Plug USB-A / USB-C / shelf light dimmer, fans power regulator and desk height regulator.



Non-adjustable table version. Plug USB-A / USB-C / shelf light dimmer, fans power regulator.

Modularity

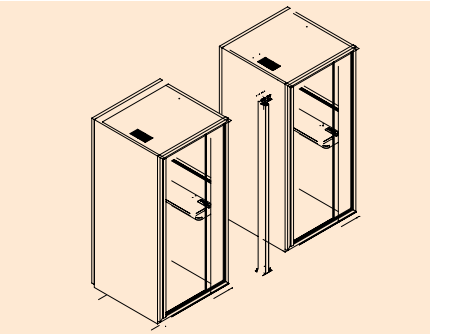

Our Kall booths can be combined in different ways to create work environments according to the needs of each user and adapt to different types of space.



UL Certified



CE Certified

Pavilion O, a modular structure to reinvent the workplace.

Many companies have adapted to the increasingly unpredictable market by creating agile organizational structures. To be agile, they also need office structures that can be easily reconfigured to suit ever-changing requirements. Pavilion O is the ideal structure solution for these new work environments.

The principal function of our Pavilion O is to provide a flexible way of dividing offices into zones while offering enclosed workspaces. It consists of an aluminum structure that can be built out with a variety of materials: glass, wood and fabric, as well as practical fittings: shelving, TV unit, whiteboards and bulletin boards. Our Pavilion O also allows for the integration of electrical cables and functional accessories that can be tailored to your company's specific needs.

Pavilion O facilitates the creation of countless office and workspace layouts that can be rapidly adapted to accommodate changes to your headcount or department functions. Thanks to its modular nature, the Pavilion O system gives you the power to respond quickly to the constantly changing modern world of work.

Modularity

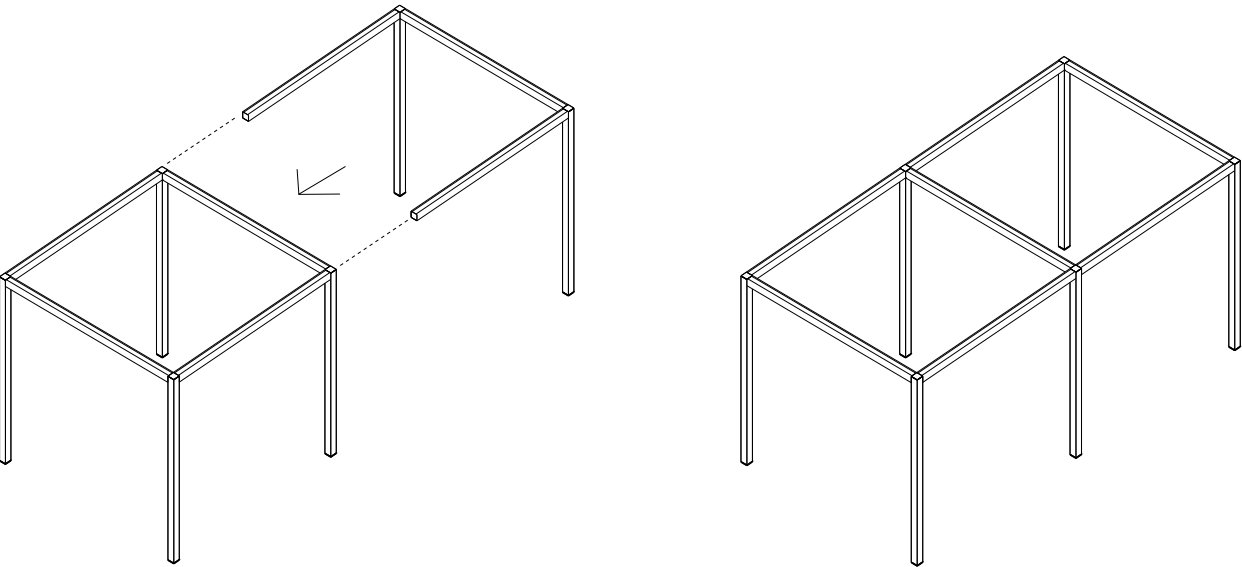

Pavilion O adapts to the context of any modern workspace. It is a dynamic way to transform your office space, thereby increasing productivity and creativity amongst your teams. It gives you the option to create several spaces; from one-person private rooms to those that can accommodate the entire team.

Your office can be set up in a variety of different configurations. The basic structure conforms to the grid layout commonly used in office planning and it has ceiling heights that can adapt to all environments.

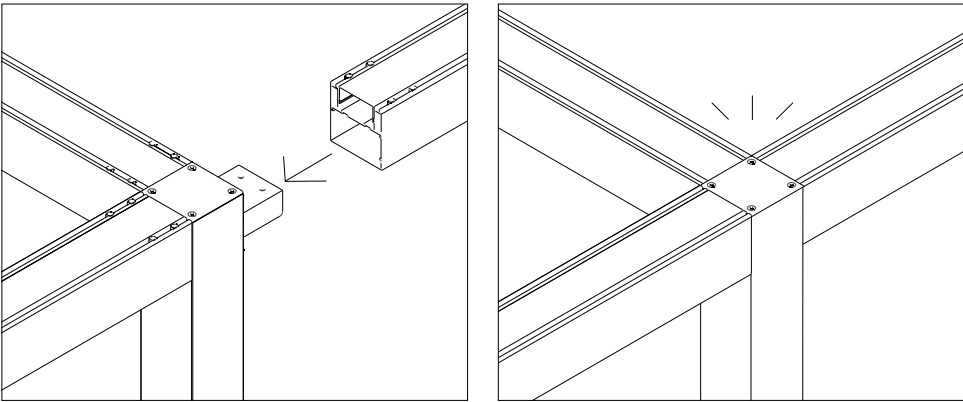

The ingenious square tube and corner connector system generates a sense of light and space.



Find out more

Click & Work

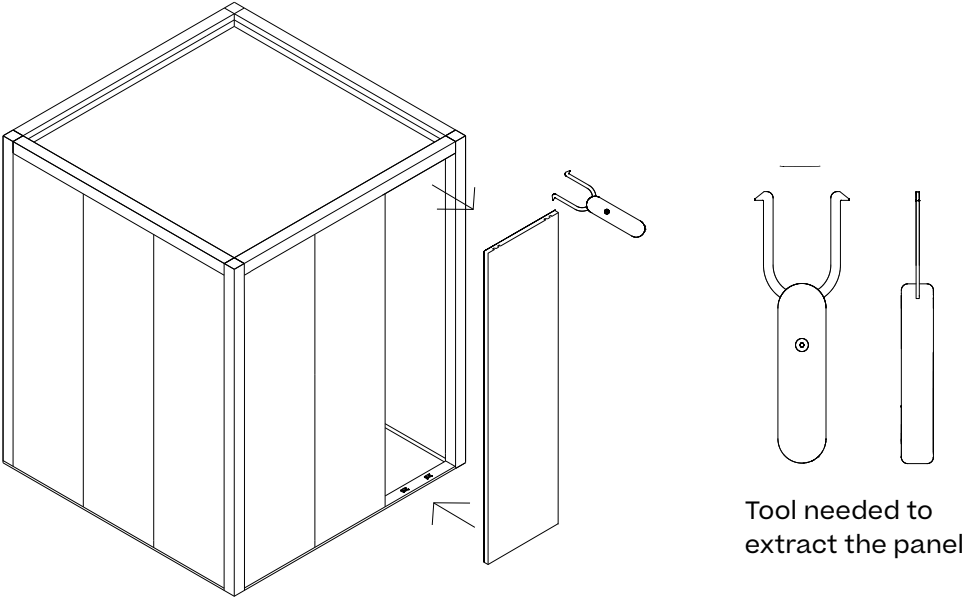

Our unique clipping system means you can transform your spaces to create your own mood ecosystems. Wall to wall or corner to corner, the scope for creating adaptable office spaces is limitless.

Configurations can be altered in a few hours to provide new spaces. A quick and easy installation demountable structure.

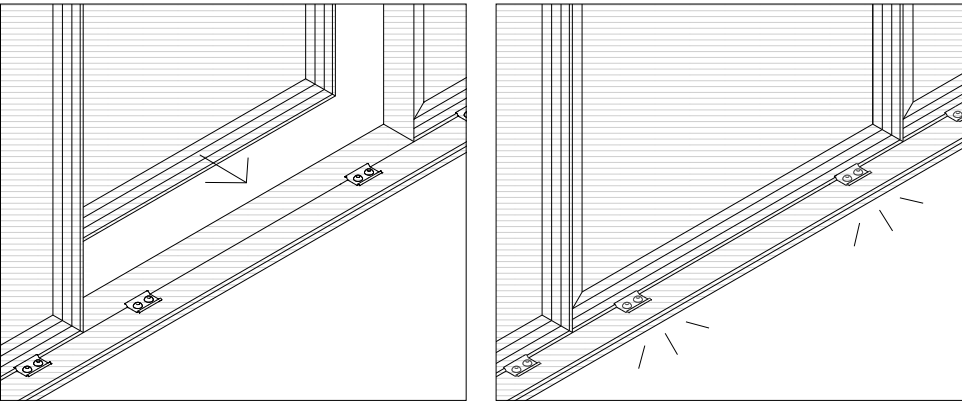

Find out more

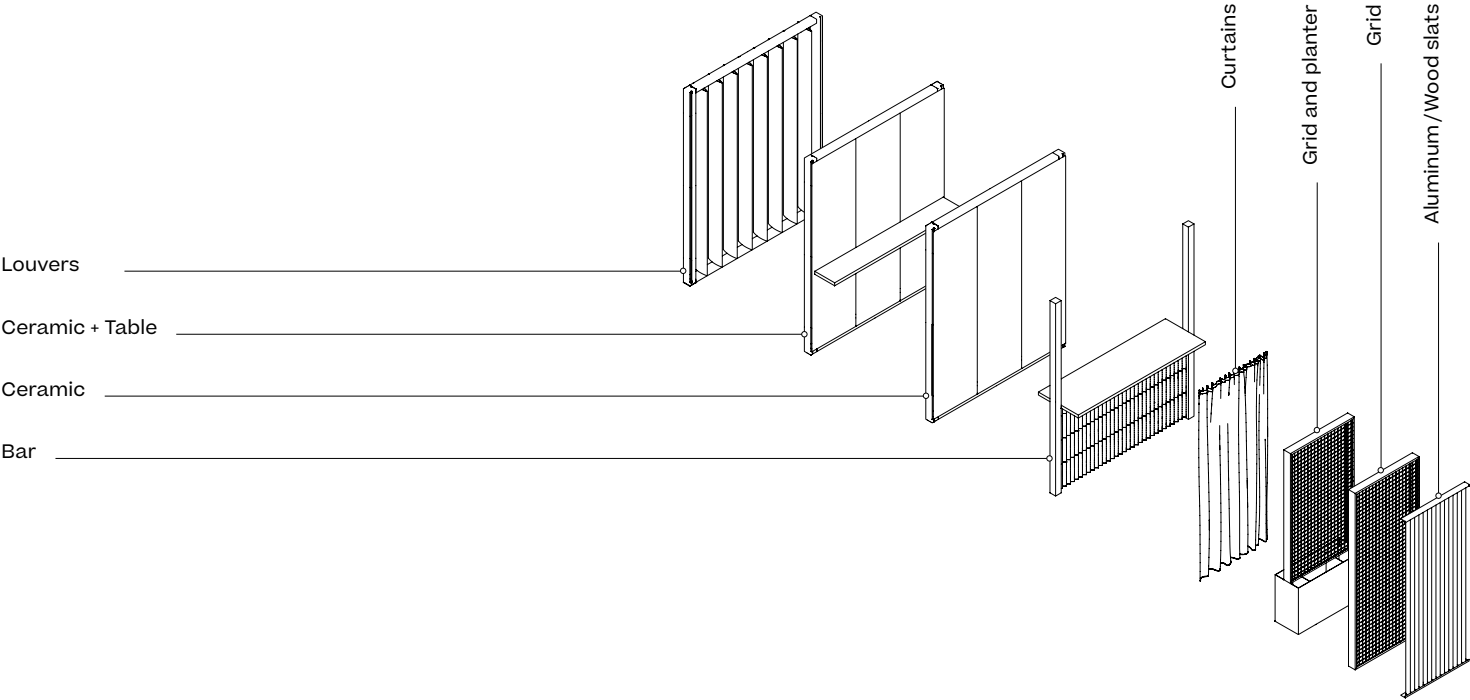

Structure

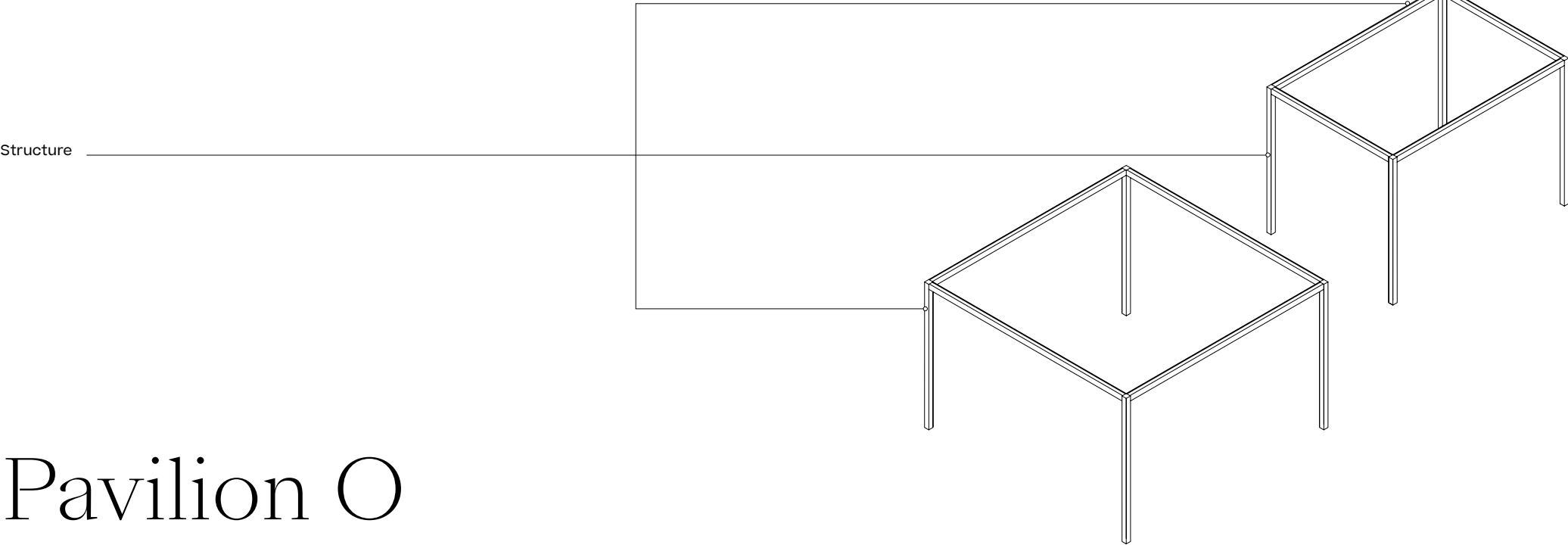

Pavilion O

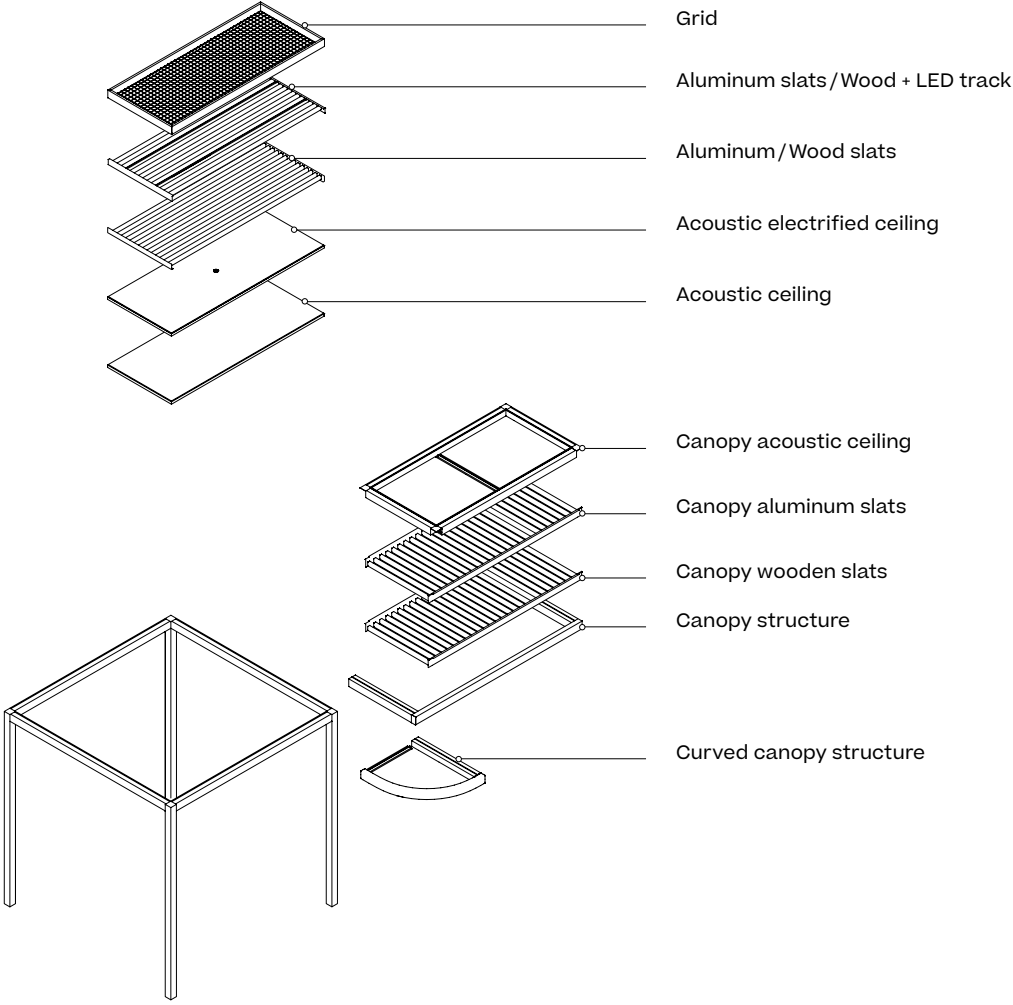
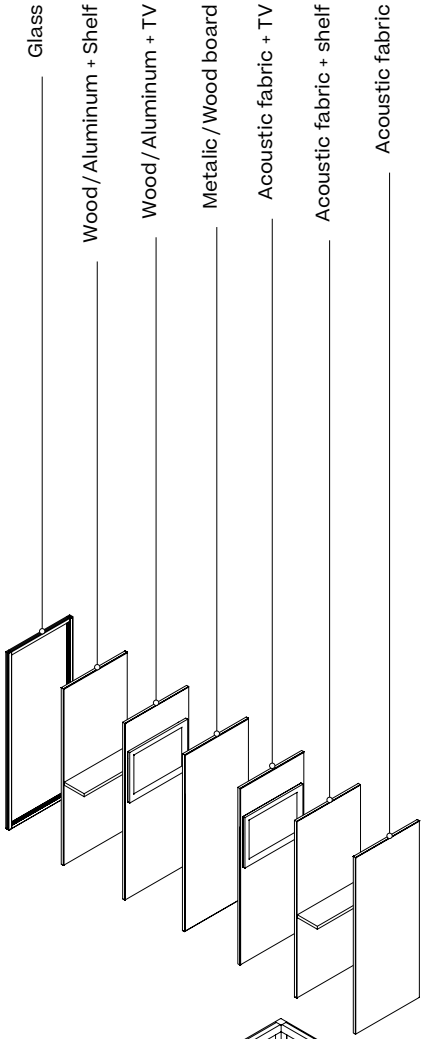

Side panels

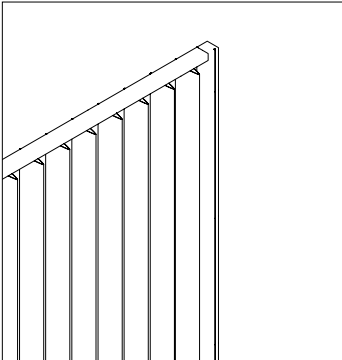

Louvers

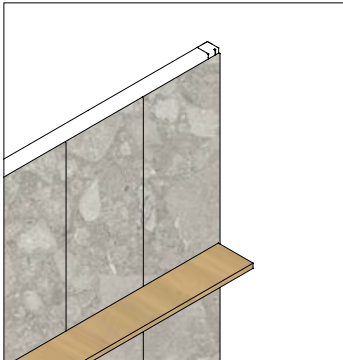

Ceramic with table

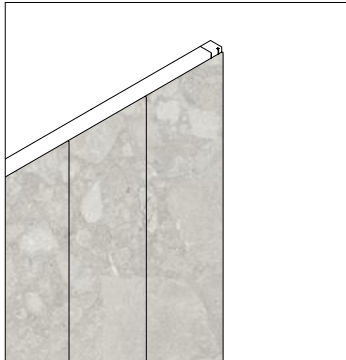

Ceramic

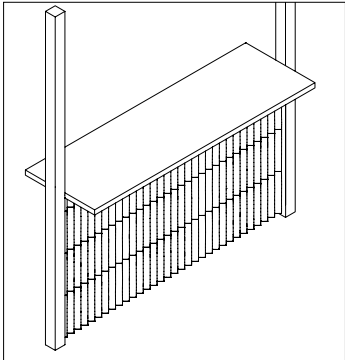

Bar

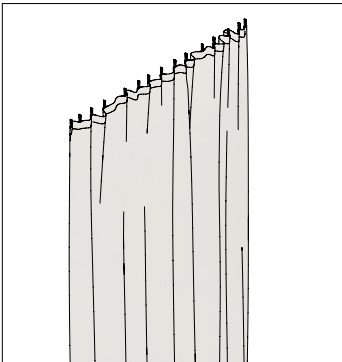

Curtains

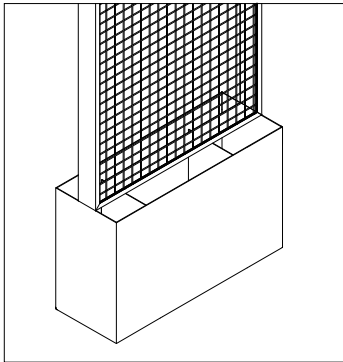

Grid with planter

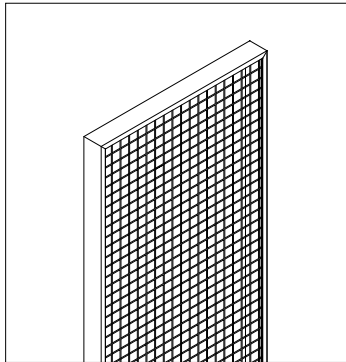

Grid

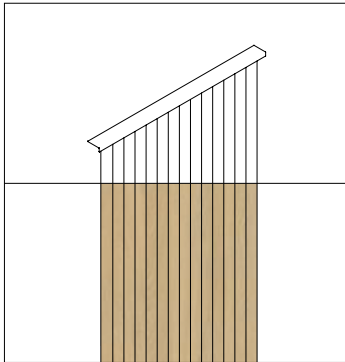

Aluminum / Wooden slats

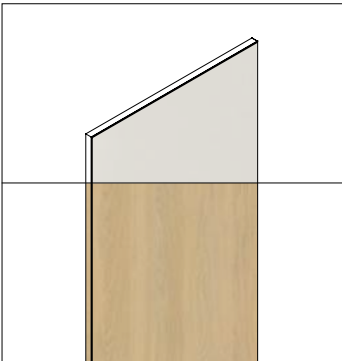

Acoustic fabric / Wood

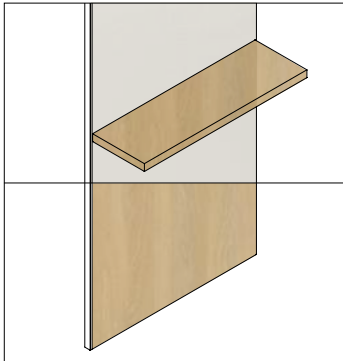

Acoustic fabric / Wood with shelf

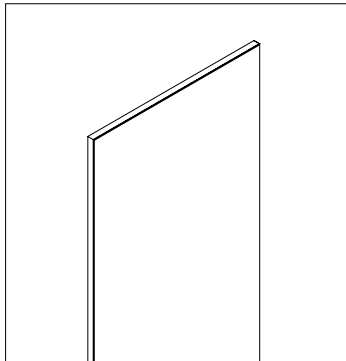

Metalic board

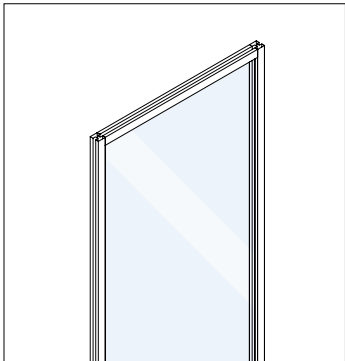

Glass

Side accessories

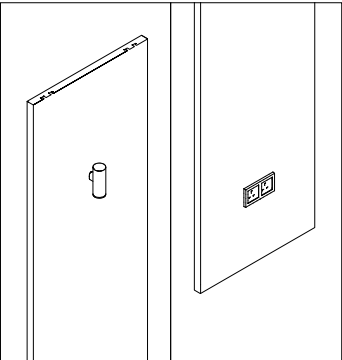

Light and plug

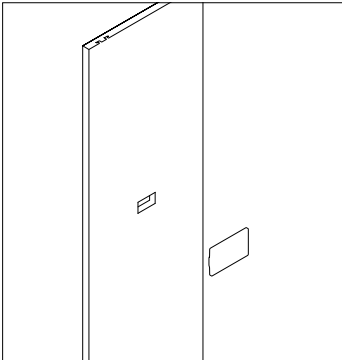

Small display

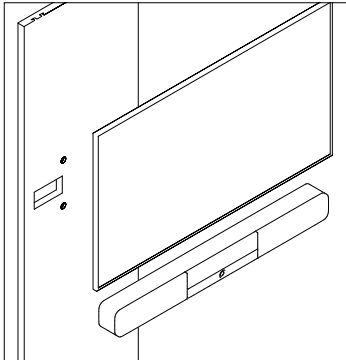

TV

Ceiling

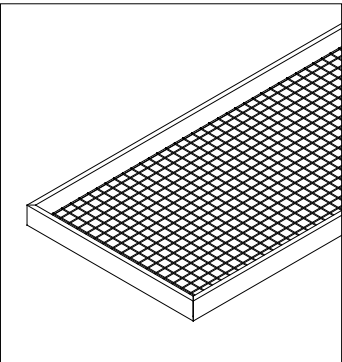

Grid

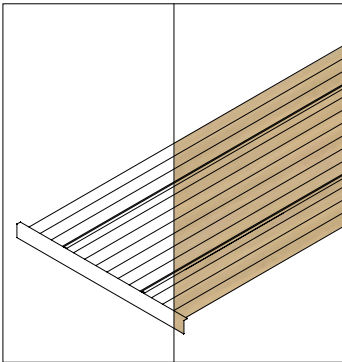

Aluminum or wooden slats with LED track

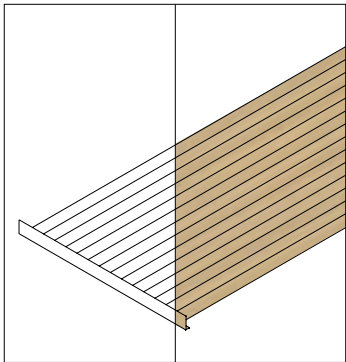

Aluminum / Wooden slats

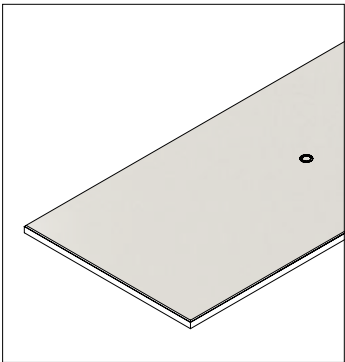

Acoustic electrified ceiling / Acoustic ceiling

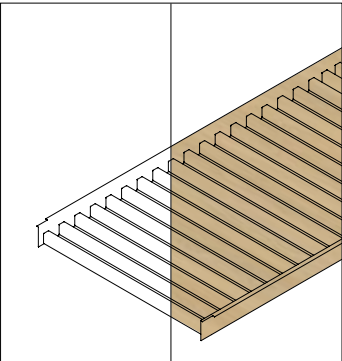

Canopy aluminum slats / Wooden slats

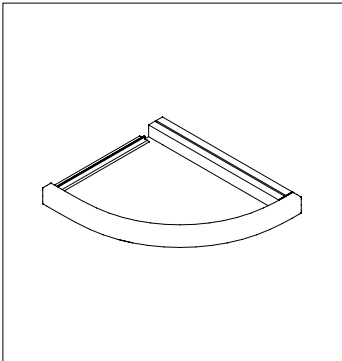

Curved canopy structure



Find out more

Focus

Certain situations require your employees to increase their focus. It might be a meeting between them and a top client or it could be a puzzling problem that requires quiet analysis. Our system can help you create spaces that allow them to excel in such situations.

Spaces tailored for those occasions when isolated work is required.

Kall

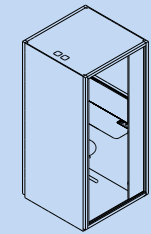

S

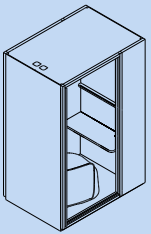

M

Phone Booth O

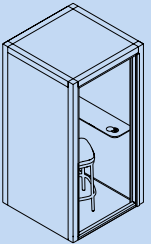

S

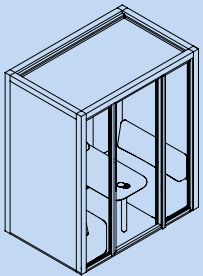

L

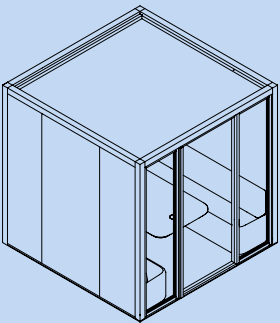

XL

Phone Booth O, by Kettal studio

Privacy can be hard to come by in large open offices. Our Phone booth O allows your employees to make calls or hold video conferences with unbroken focus and without disturbing the rest of the team. The Phone booth O design is inspired by the traditional telePhone booth. They are an elegant yet functional solution for your office. Comfortable and echo-free, the Phone booth O is also simple to install.











Phone booth O
S

KSB300100

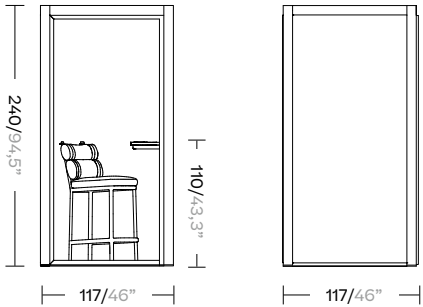

Phone booth O
L

KSB300200

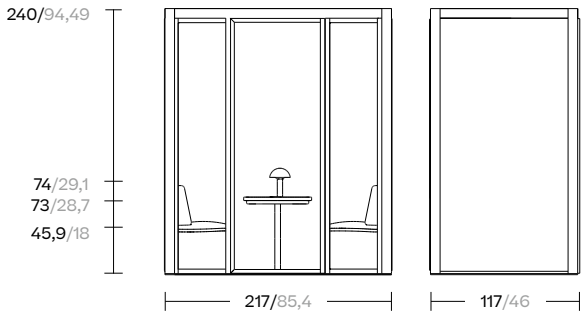

Phone booth O
XL

KSB300200

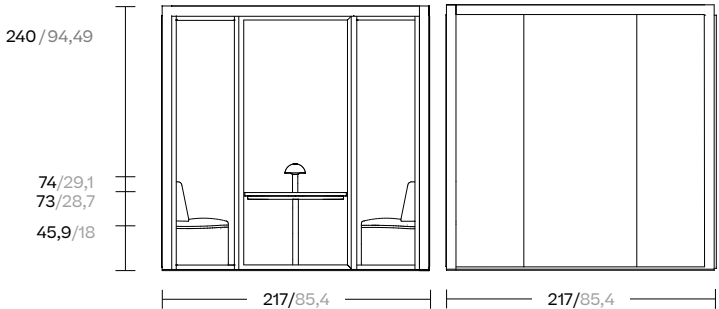

Specifications

- 4+4 or 6+6 mm
- Pivot door
- Aluminium frame
- Acoustic panels
- Absorption system
- Fabric or glass
- Faced external wall
- Air ventilation system
- LED lighting
- PIR sensor



See video here



Table with Plug / USB- A / USB-C



Shelf + Led light + PIR



LED track curtain



Handicap flooring, pivoting door



Plug and play



Ventilation system

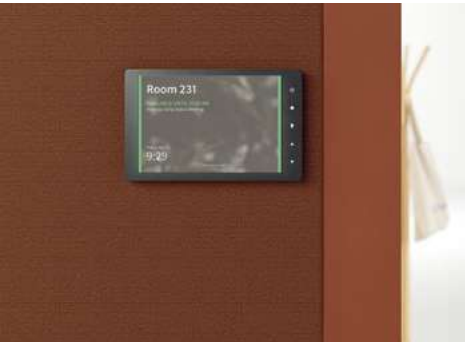

Crestron screen (optional)



Reconfigurable

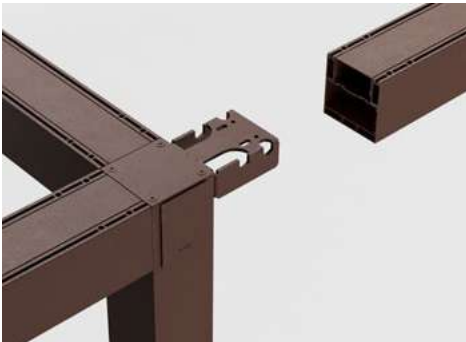

Modularity



DDA/ADA Compliant

A DDA / ADA compliant Phone Booth O is available as a model of our commitment to make it accessible for everyone

Meeting

Whether it is a meeting with colleagues or clients, you want to optimize its effectiveness. Comfort is crucial — particularly when your meeting is long in duration. We recognize this and have designed accordingly. Our superior sound insulation provides a quiet, distraction-free environment for holding your meetings without disturbing those in the vicinity.

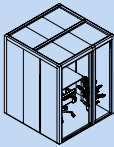

Meeting Room
2 persons

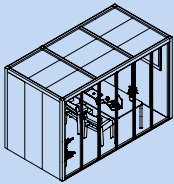

Meeting Room
2/4 persons

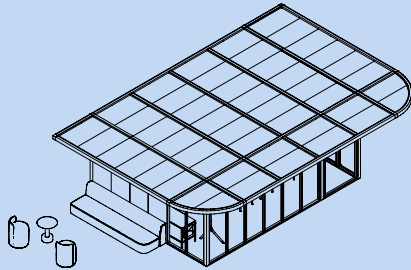

Meeting Room
4/6 persons

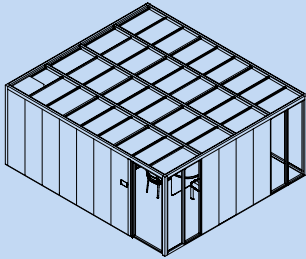

Meeting Room
6/8 persons

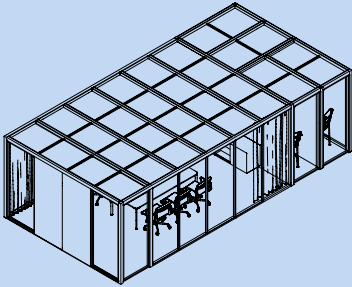

Meeting room
Special sizes

Comfort and silence means better communication and better meetings.

Meeting room

2 persons



Description

A meeting room fitting 2 persons. You can sit down alone for a meeting with your clients or colleagues who are participating remotely. The exceptional acoustics and physical comfort allow for better communication, as well as concentration.

The adaptable system allows for the integration of additional open modules with different functions.

Specifications

- 4+4 or 6+6 mm
- Pivot door
- Aluminium frame
- Acoustic panels
- Absorption system
- Fabric/Metal/Wood/Glass
- Faced external wall
- Air ventilation system
- LED lighting
- PIR sensor
- Adaptable and modular
- AV systems option
- Dimmable lights



Meeting room

2/4 persons

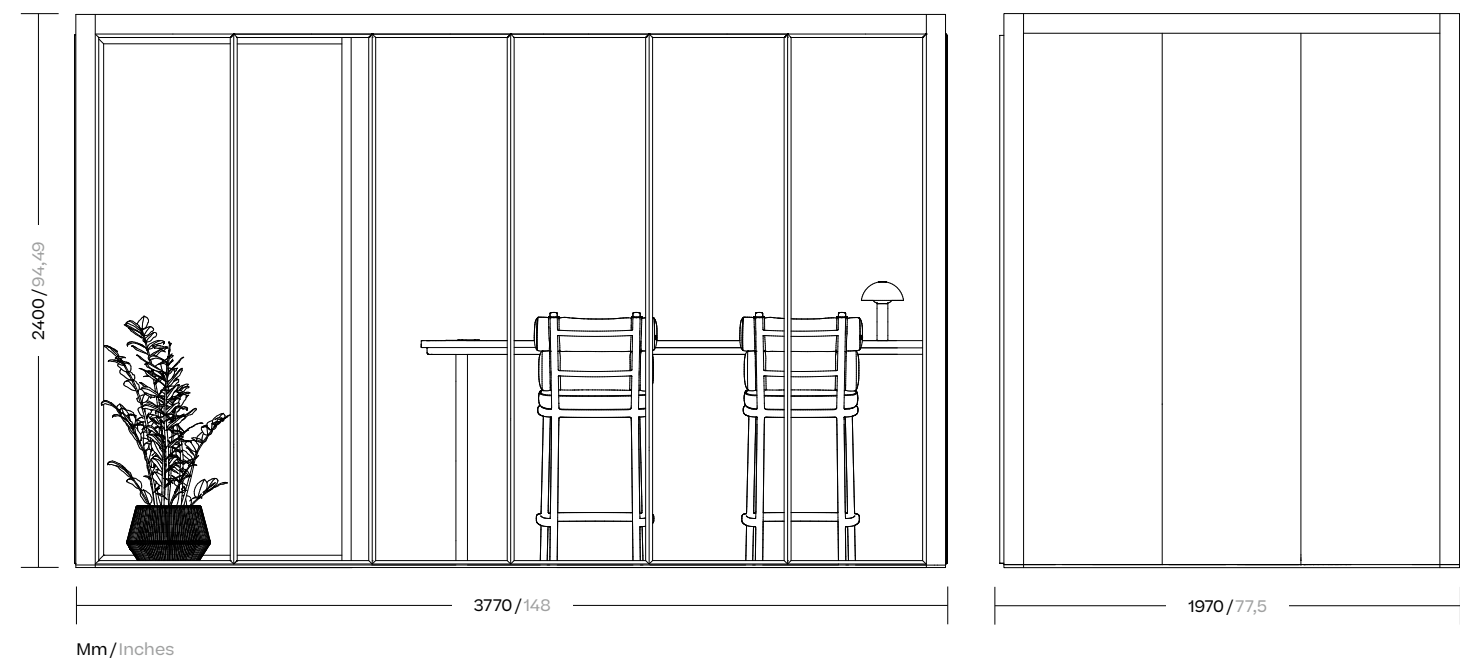

Description

Gather with a group of up to four to conduct a meeting. The exceptional acoustics and physical comfort allow for better communication, as well as concentration.

The adaptable system allows for the integration of additional open modules with different functions.

Specifications

- 4+4 or 6+6 mm
- Pivot door
- Aluminium frame
- Acoustic panels
- Absorption system
- Fabric/Metal/Wood/Glass
- Faced external wall
- Air ventilation system
- LED lighting
- PIR sensor
- Adaptable and modular
- Dimmable lights
- AV systems option





Meeting room

4/6 persons

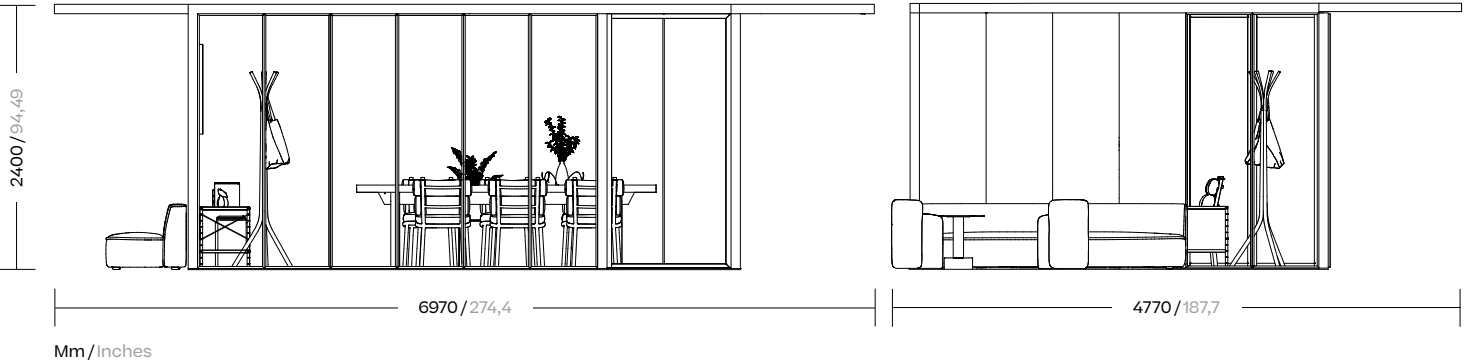

Description

A meeting room that can accomodate up to 6 persons. The exceptional acoustics and physical comfort allow for better communication, as well as concentration.

The adaptable system allows for the integration of additional open modules with different functions.

Specifications

- 4+4 or 6+6 mm
- Pivot door
- Aluminium frame
- Acoustic panels
- Absorption system
- Fabric/Metal/Wood/Glass
- Faced external wall
- Air ventilation system
- LED lighting
- PIR sensor
- Adaptable and modular
- Dimmable lights
- AV systems option





Meeting room

6/8 persons



Video here



Description

A meeting room for up to 8 persons. The exceptional acoustics and physical comfort allow for better communication, as well as concentration.

The adaptable system allows for the integration of additional open modules with different functions.

Specifications

- 4+4 or 6+6 mm
- Pivot door
- Aluminium frame
- Acoustic panels
- Absorption system
- Fabric/Metal/Wood/Glass
- Faced external wall
- Air ventilation system
- LED lighting
- PIR sensor
- Adaptable and modular
- Dimmable lights
- AV systems option







Meeting room

Special size

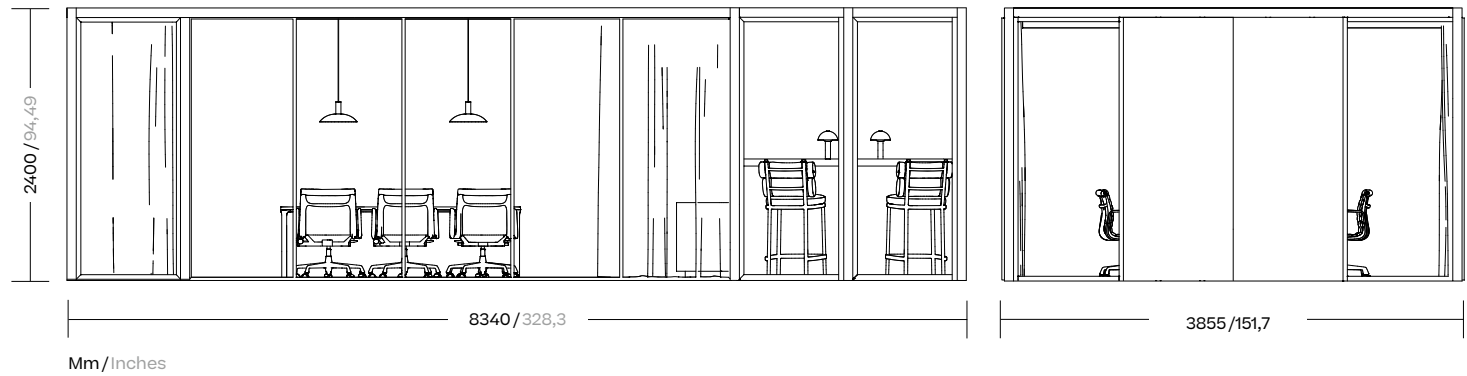

Description

A meeting room accommodating up to 10 persons. The exceptional acoustics and physical comfort allow for better communication, as well as concentration.

The adaptable system allows for the integration of additional open modules with different functions.

Specifications

- 4+4 or 6+6 mm
- Pivot door
- Aluminium frame
- Acoustic panels
- Absorption system
- Fabric/Metal/Wood/Glass
- Faced external wall
- Air ventilation system
- LED lighting
- PIR sensor
- Adaptable and modular
- Dimmable lights
- AV systems option







Hub

Hub offers you a third-space within your actual office space. Your employees can mingle for chats, impromptu brainstorming sessions or perhaps a quick coffee after an intense meeting with a top client. The flexibility of our Hub system enables you to create scenes that complement whatever vision you have for your office culture.

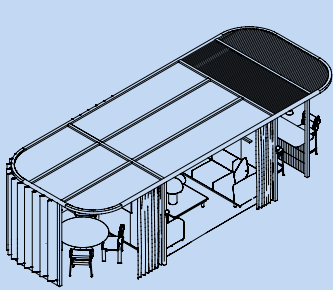

Hub Curved

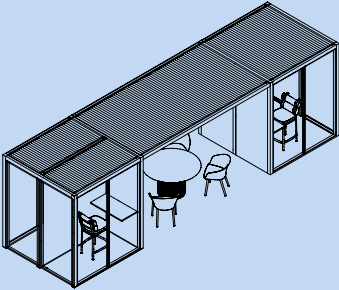

Hub Walk Through

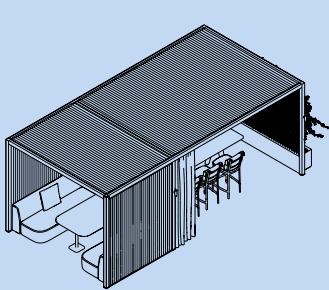

Hub Open
With Meeting & Sofas

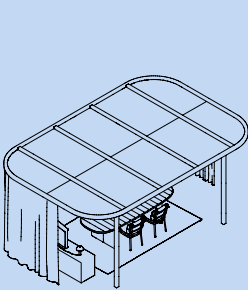

Hub Open
With Curtains

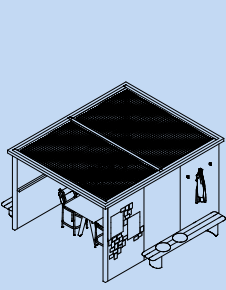

Hub Open

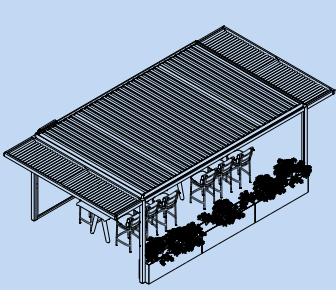

Hub Outdoor

Hybrid structures to connect your staff in a social way.

Hub Curved

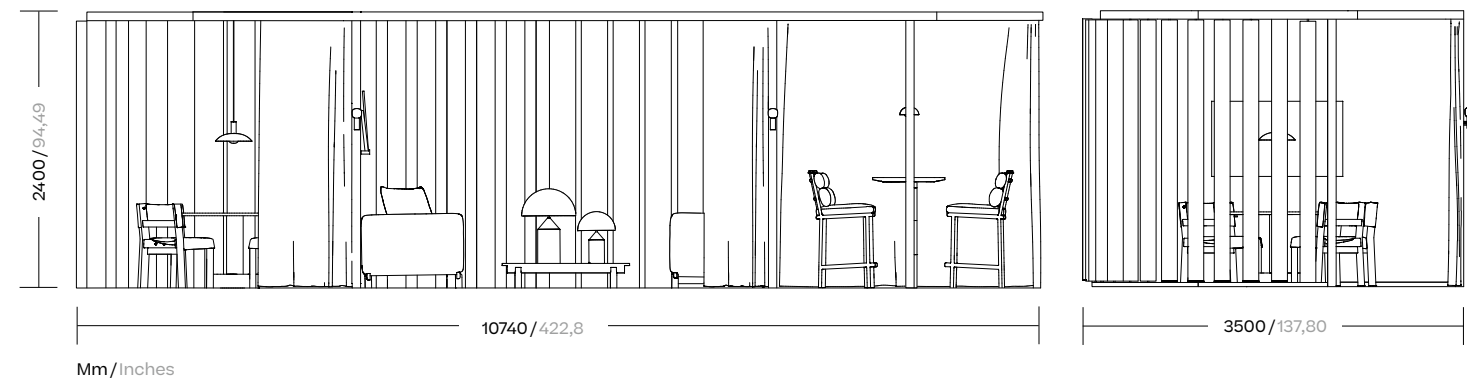

Description

Three zones under one roof. Whether it is for sitting, meeting or taking a break, this curved structure will suit a variety of casual or impromptu interactions.

Specifications

- 4+4 or 6+6 mm
- Pivot door
- Aluminium frame
- Acoustic panels
- Absorption system
- Fabric/Metal/Wood/Ceramic/Glass
- Faced external wall
- Air ventilation system
- LED lighting
- PIR sensor
- Adaptable and modular
- Dimmable lights
- AV systems option







Hub Walk Through

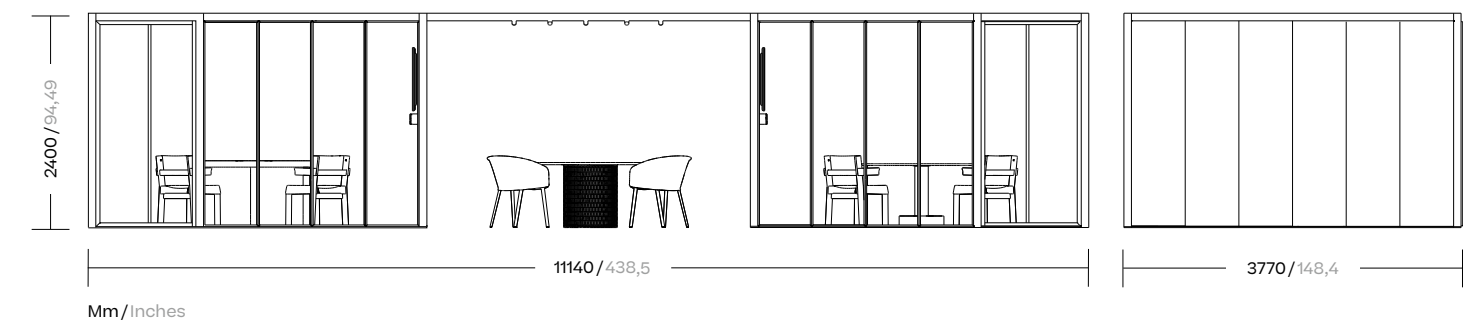

Description	Specifications	
Two spacious meeting rooms on either side of a more casual open gathering point. Suitable for either formal or relaxed interactions.	<ul style="list-style-type: none">• 4+4 or 6+6 mm• Pivot door• Aluminium frame• Metal frame• Acoustic panels• Absorption system• Fabric / Metal / Wood / Ceramic / Glass	<ul style="list-style-type: none">• Faced external wall• Air ventilation system• LED lighting• PIR sensor• Adaptable and modular• Dimmable lights• AV systems option





Hub Open

With meeting & Sofas

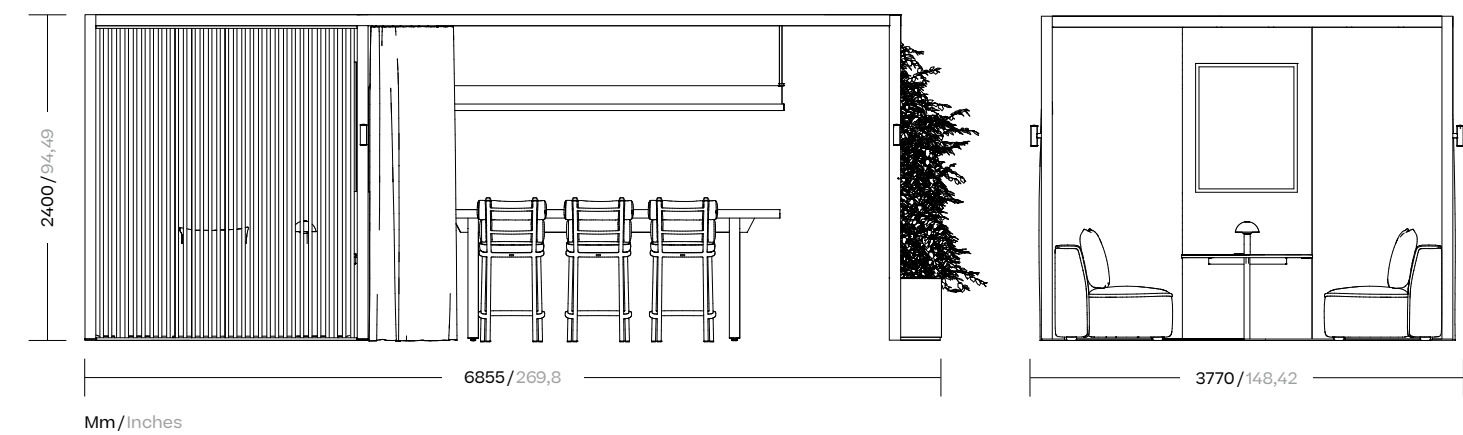

Description

A six-person, high-table discussion space attached to a sofa area. Suitable for a variety of semi private gatherings.

Specifications

- Single or double glazed wall system
- Pivot door
- Metal frame
- Acoustic panels
- Absorption system
- Fabric/Metal/Wood/Ceramic/Glass
- Faced external wall
- Air ventilation system
- LED lighting
- PIR sensor
- Adaptable and modular
- Dimmable lights
- AV systems option





Hub Open With Curtains

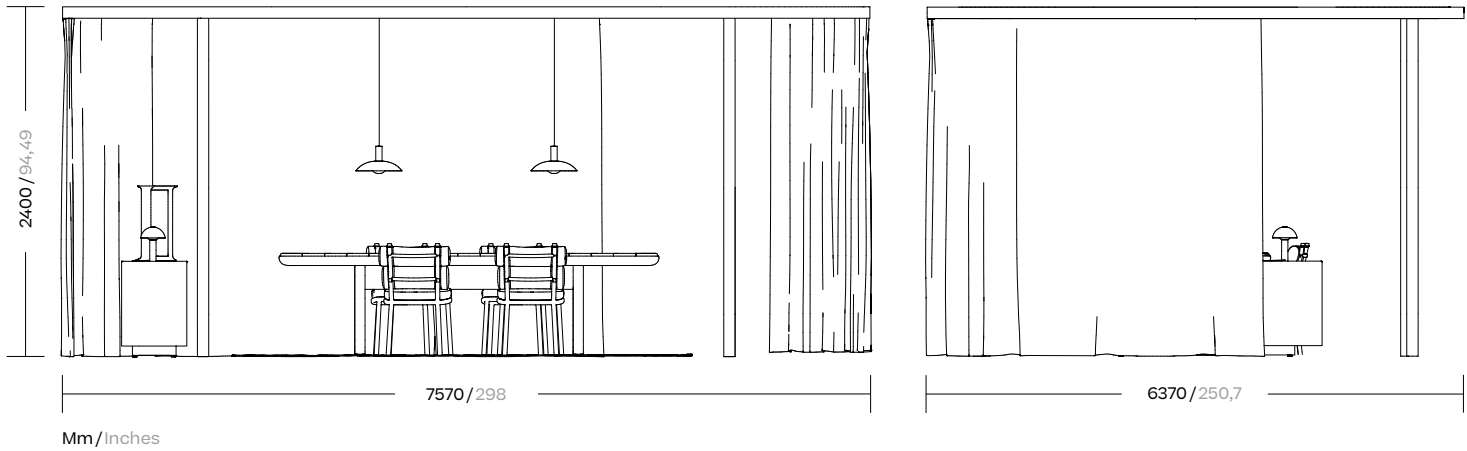

Description

An open meeting space with curtains that add an atmospheric, living room-like comfort. Suitable for a small group to meet in a relaxed fashion.

Specifications

- 4+4 or 6+6 mm
- Pivot door
- Aluminium frame
- Metal frame
- Acoustic panels
- Absorption system
- Fabric / Metal / Wood / Ceramic / Glass
- Faced external wall
- Air ventilation system
- LED lighting
- PIR sensor
- Adaptable and modular
- Dimmable lights
- AV systems option





Hub Open

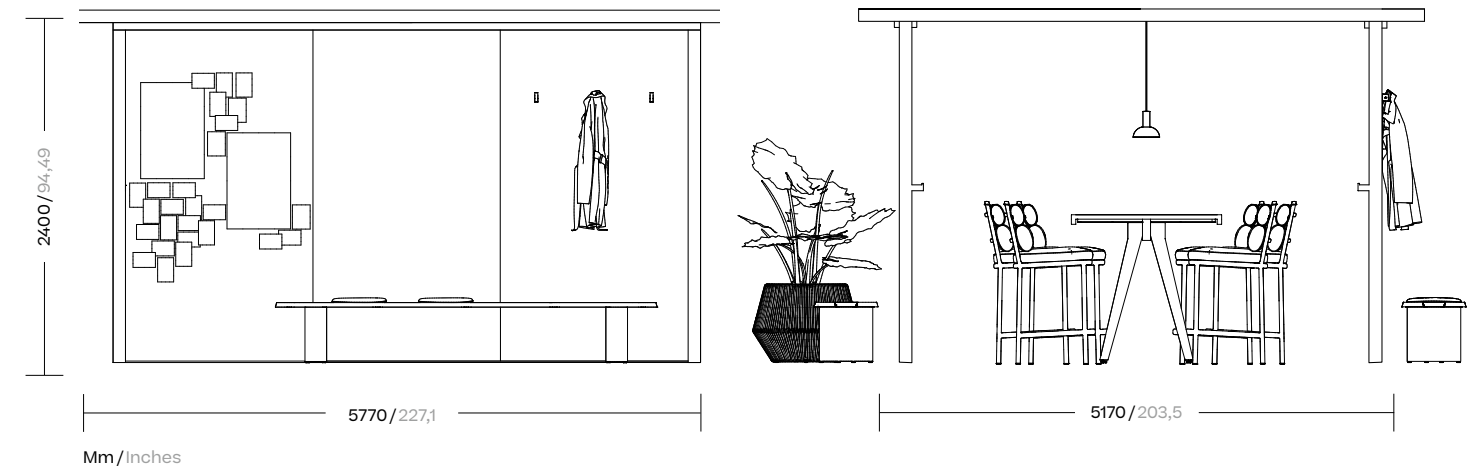

Description

An open and creative space, ideal for brainstorming on the go. Includes a small bench at the rear.

Specifications

- | | |
|-----------------------------------|--------------------------|
| • 4+4 or 6+6 mm | • Faced external wall |
| • Pivot door | • Air ventilation system |
| • Aluminium frame | • LED lighting |
| • Metal frame | • PIR sensor |
| • Acoustic panels | • Adaptable and modular |
| • Absorption system | • Dimmable lights |
| • Fabric/Metal/Wood/Ceramic/Glass | • AV systems option |





Hub Outdoor

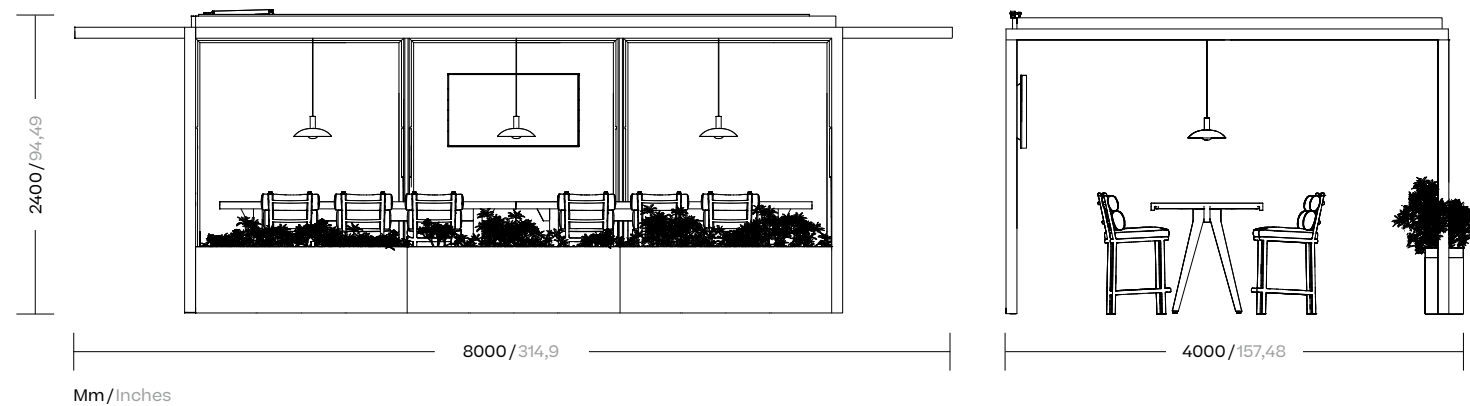

Description

We designed the pavilion from the perspective of adaptability and it is therefore extremely versatile. It can be integrated not only with indoor spaces but also with outdoor ones. Its flexible and modular structures enable it to be used as a large shade and even for the creation of covered walkways.

Specifications

- Pavilion H profile
- Aluminium frame
- Accesories
- Fabric, glass, wood, stone
- LED lighting
- PIR sensor





Support

From receptions and printing areas to kitchens and lockers, there are additional areas that every modern office is expected to have. We have designed structures that can provide for all of these support areas in a most stylish way.

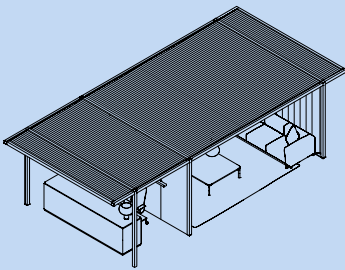

Reception & Lounge

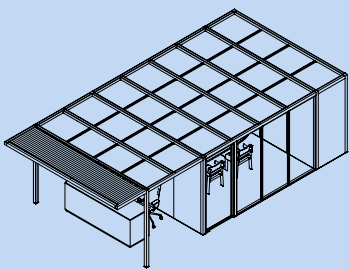

Reception With Meeting
& Printing Area

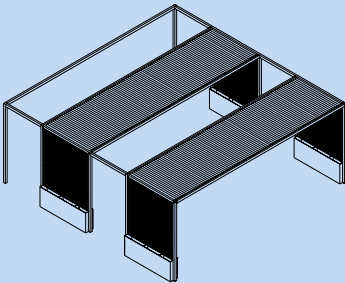

Lockers

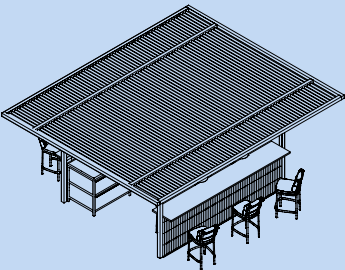

Kitchen

Functional spaces that support the smooth running of your business.

Reception

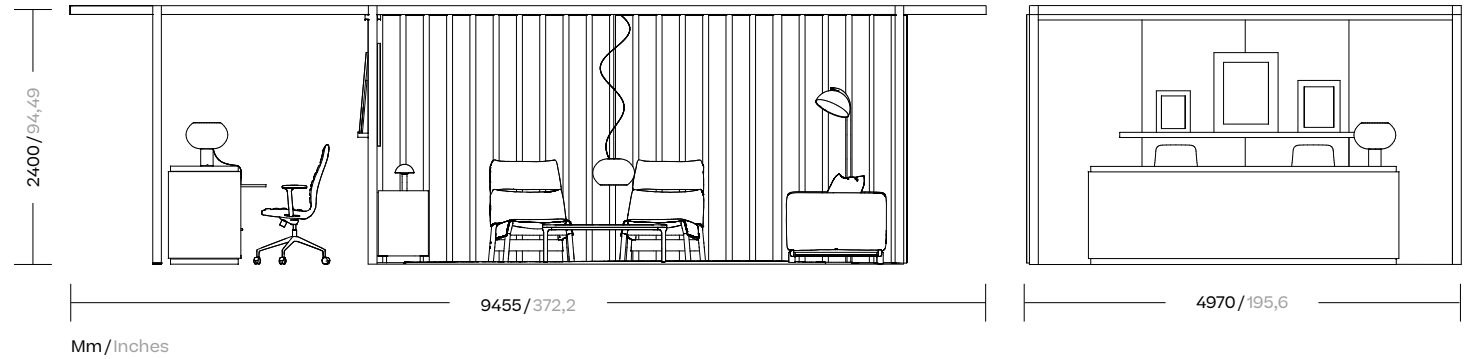

Description

A sleek reception and waiting area that also impresses visiting clients.

Specifications

- 4+4 or 6+6 mm
- Pivot door
- Aluminium frame
- Acoustic panels
- Absorption system
- Fabric or glass
- Faced external wall
- Air ventilation system
- LED lighting
- PIR sensor





Reception With Meeting & Printing Area

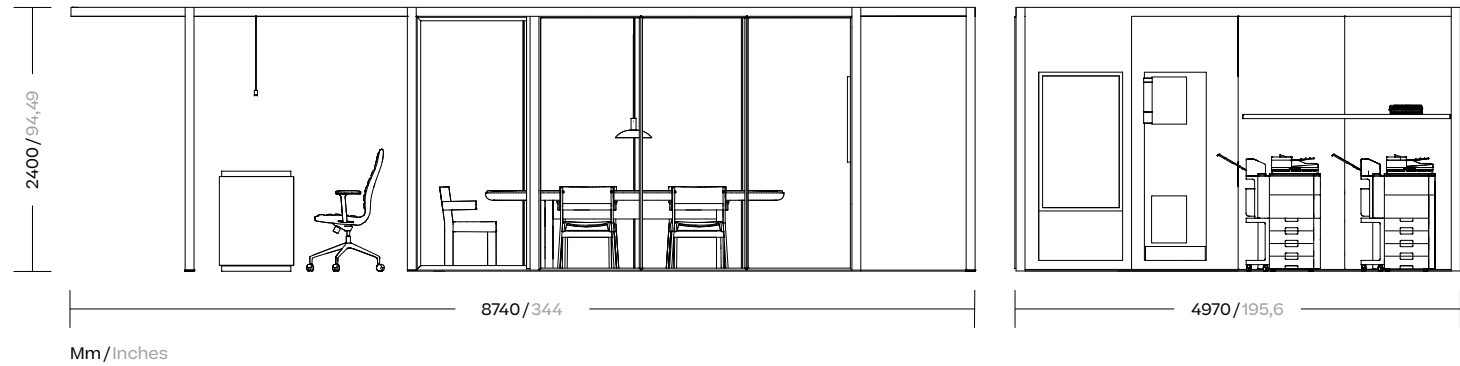

Description

A dedicated printing area that neighbors a smart reception and spacious meeting room to support your business operations.

Specifications

- 4+4 or 6+6 mm
- Pivot door
- Aluminium frame
- Acoustic panels
- Absorption system
- Fabric or glass
- Faced external wall
- Air ventilation system
- LED lighting
- PIR sensor







Lockers

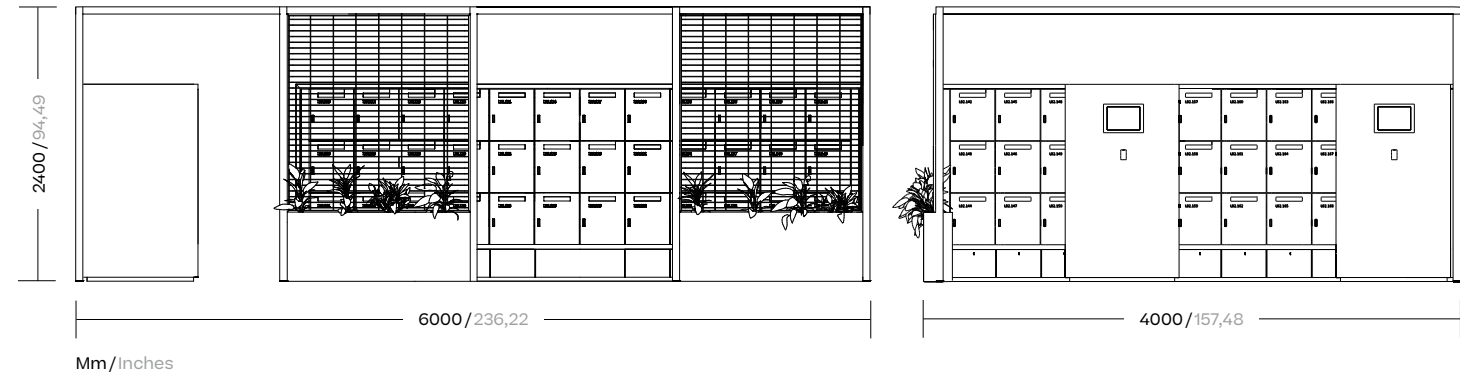

Description	Specifications
A convenient locker area to support your employees and their lifestyles.	<div><ul style="list-style-type: none">• 4+4 or 6+6 mm• Pivot door• Aluminium frame• Acoustic panels• Absorption system• Fabric or glass• Faced external wall</div> <div><ul style="list-style-type: none">• Air ventilation system• LED lighting• PIR sensor</div>





Kitchen

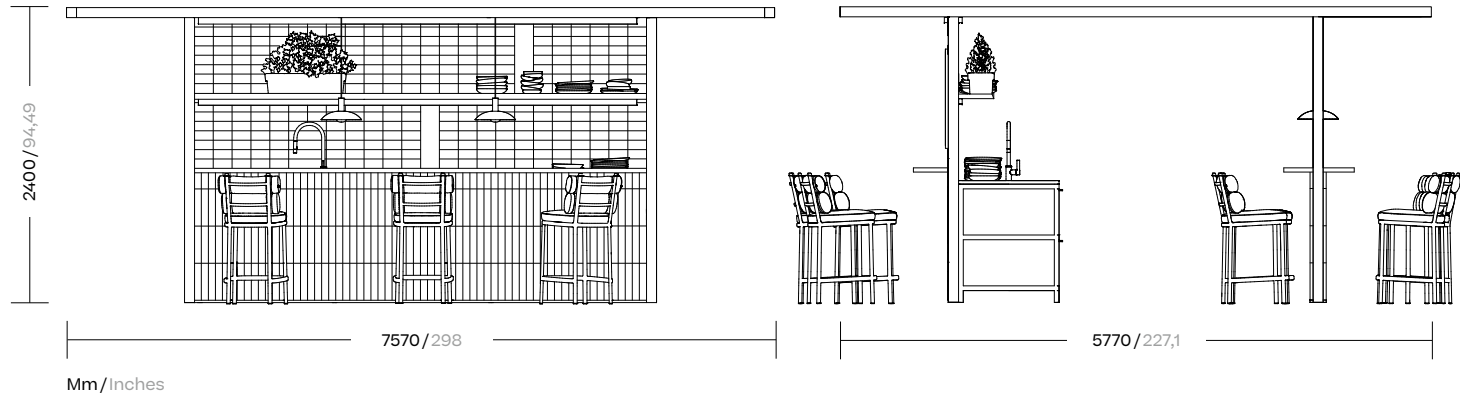

Description

A clever and open kitchen to support your employees while they recharge and interact with each other.

Specifications

- 4+4 or 6+6 mm
- Pivot door
- Aluminium frame
- Acoustic panels
- Absorption system
- Fabric or glass
- Faced external wall
- Air ventilation system
- LED lighting
- PIR sensor





Lighting

A space cannot be designed without careful consideration of lighting. For this reason, we have created a new language of light, from the ground up, that elegantly integrates into the architecture.

We are not just another lighting company. But we know an adequate amount of light and a clever placement improves mood and energy levels, which is essential to consider in the well running of the workspace.

Elegantly integrated lighting
that rounds out your workspaces.

This lighting system is adaptable to all situations: conversation, concentration, relaxation and more. Form, function and performance is driving the fusion of technology and emotion.

LED Track Curtain

A recessed lighting system equipped with an LED light source. Specially designed for wall-washer lighting, the LED Curtain incorporates lenses to provide optimum light distribution. The LED Curtain range is available in different lengths which means it can be adjusted to suit any space, while its compact size facilitates simple integration within the Pavilion O system.

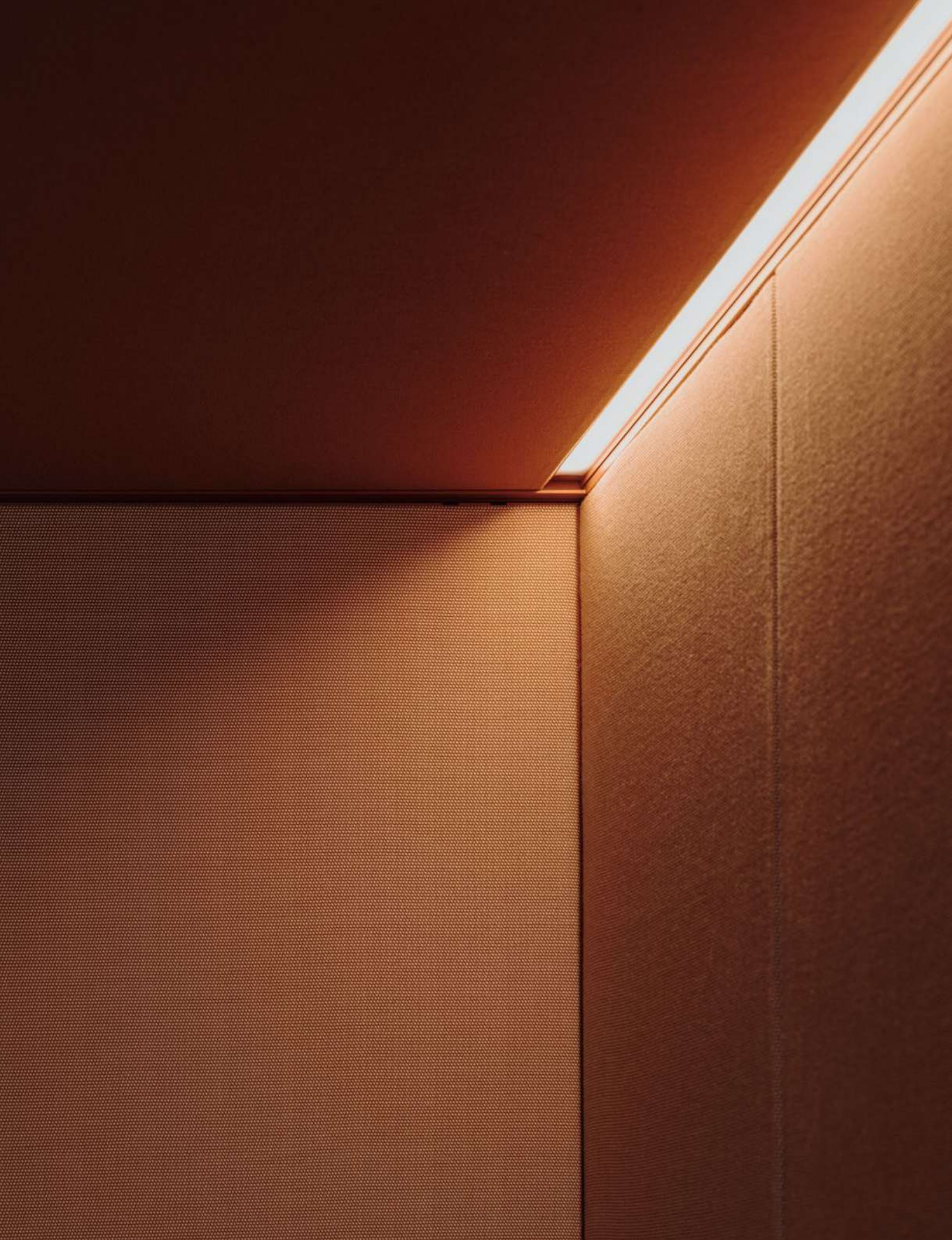
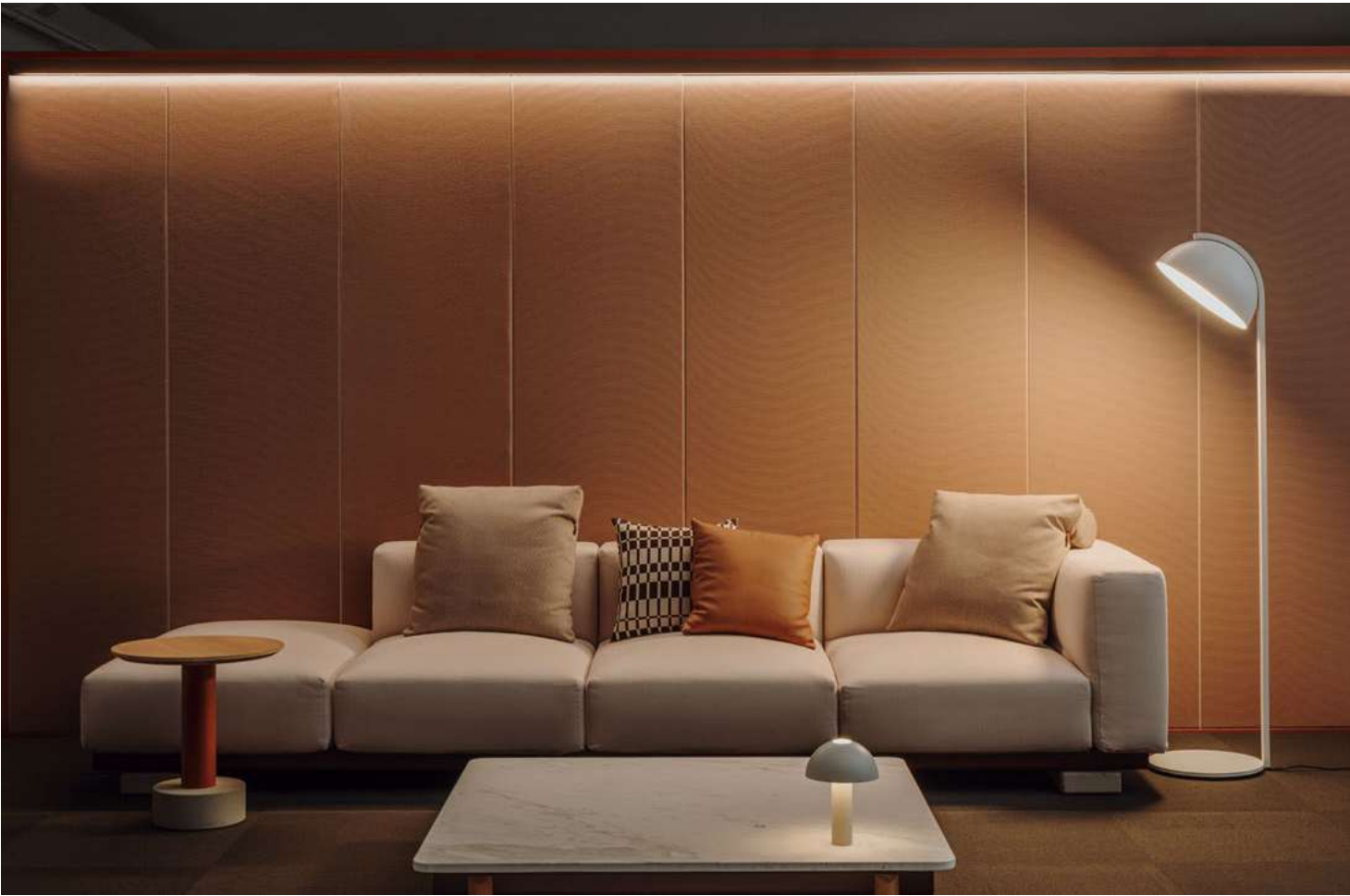



Lighting

LED Track

An integrated LED lighting system that offers solutions suited to any type of installation. It provides pleasant and efficient visual comfort, combined with high-quality performance and aesthetics.

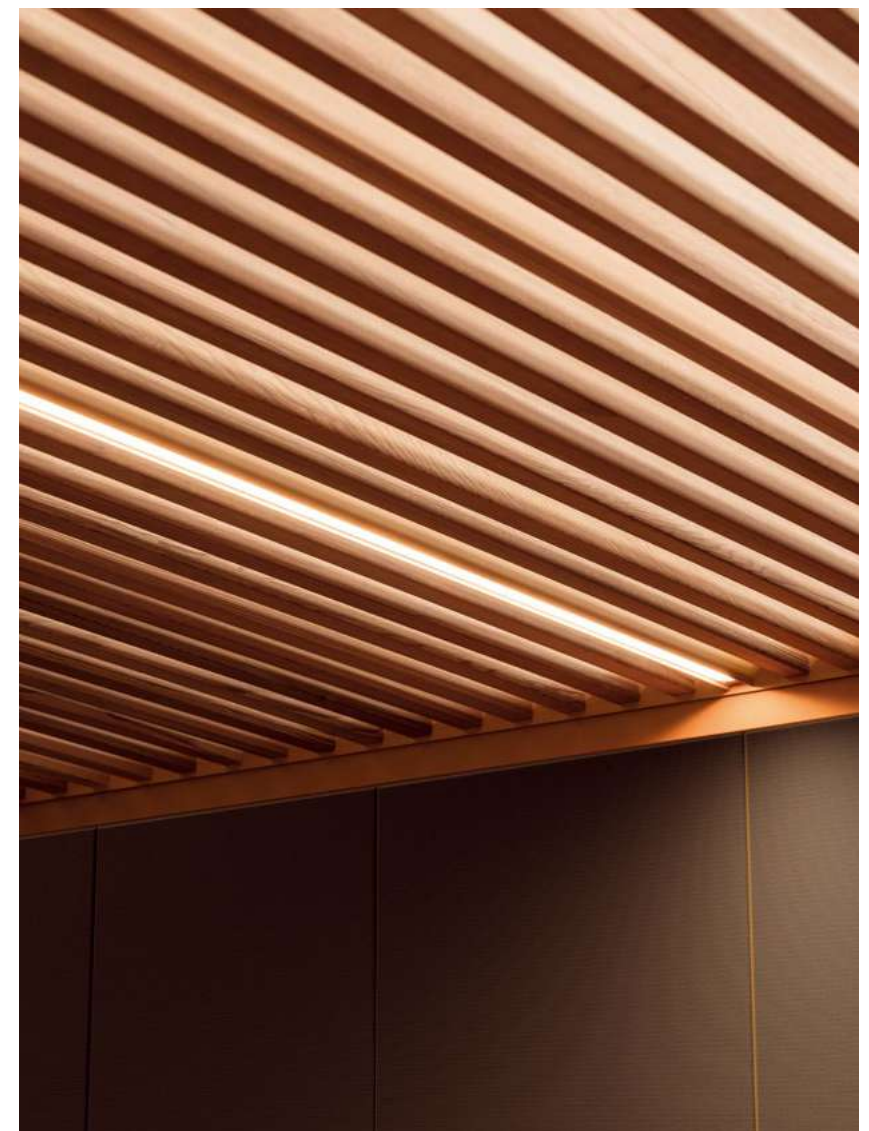

LED Track Suspension



This system consists of a bar that combines direct or indirect light, suspended by two coaxial cables that provide support and the electrical wiring. Perfect for offices that require excellent light efficiency and visual comfort.



LED Track Articulated

Our surface-mounted range that uses an LED light source. This system is composed of linear LED strips mounted on aluminum extrusion micro-profiles of varying lengths. These light modules are combined with adjustable 360° Dots spotlights that are available with different beam optics.

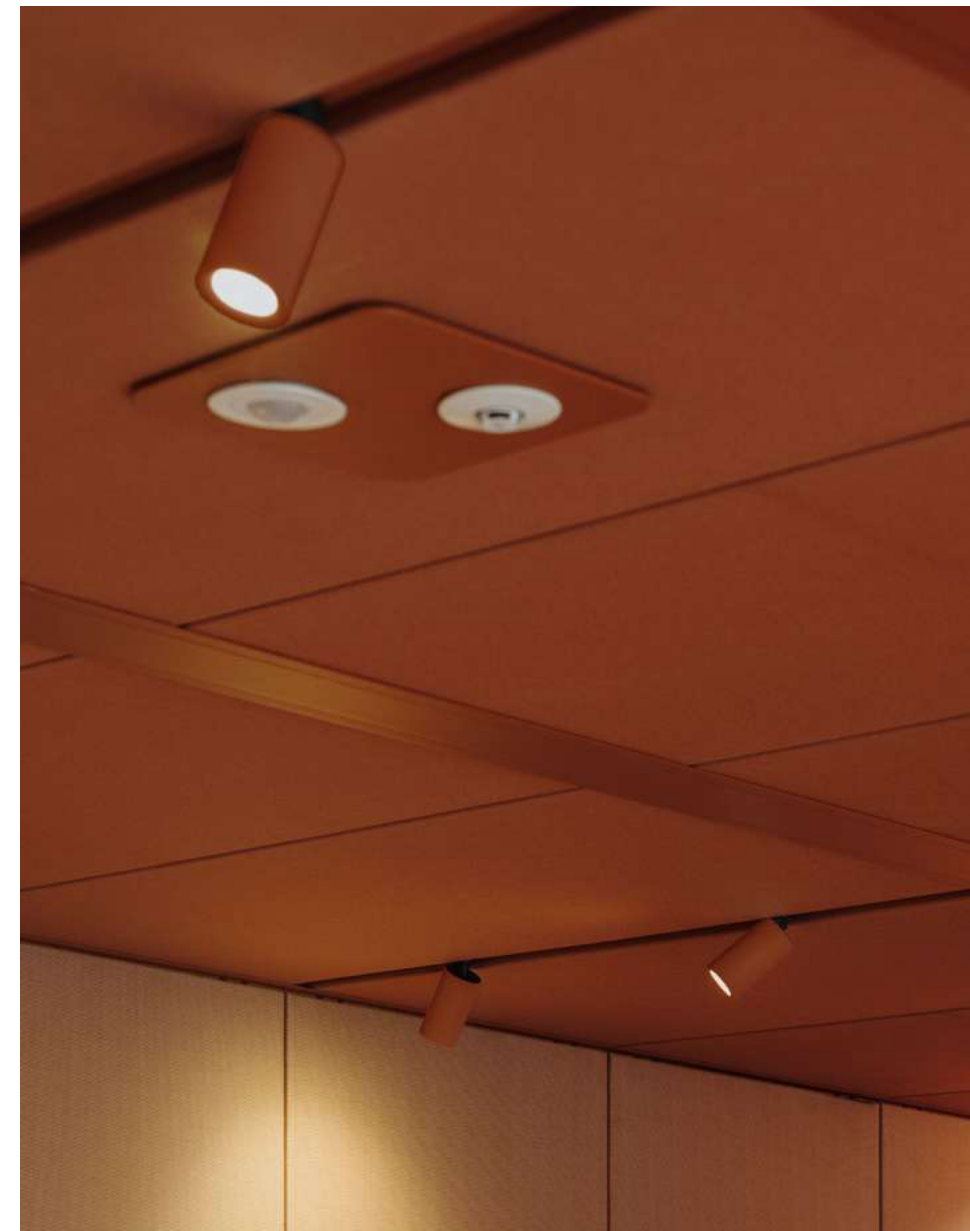

Dots Pendant



This suspended light is based on the Dots spotlight system. With its two open and closed diffusers, it directs most of the light downwards. By directing most of the light downwards, the shade is molded to illuminate spaces while protecting peoples' eyes from any direct glare. The matte white interior of the elliptical shade helps create a uniform light that is ideal for both directed and general ambient lighting needs.

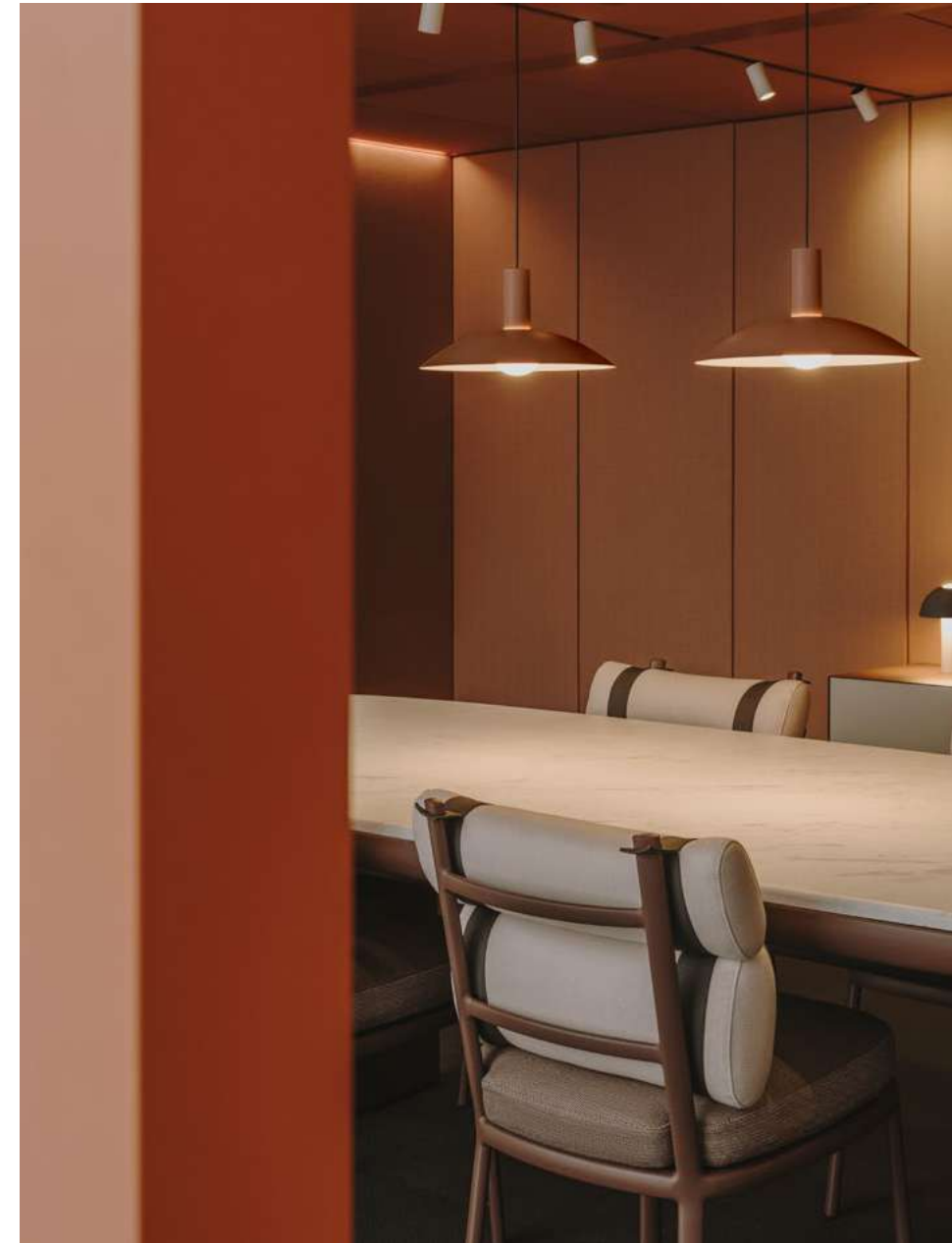



Dots Phonebooth



Lighting

The Dots Phonebooth is a professional table lamp with direct light. The base and diffuser is made of colored aluminum. It exceeds common lighting standards for applications in work and study environments.

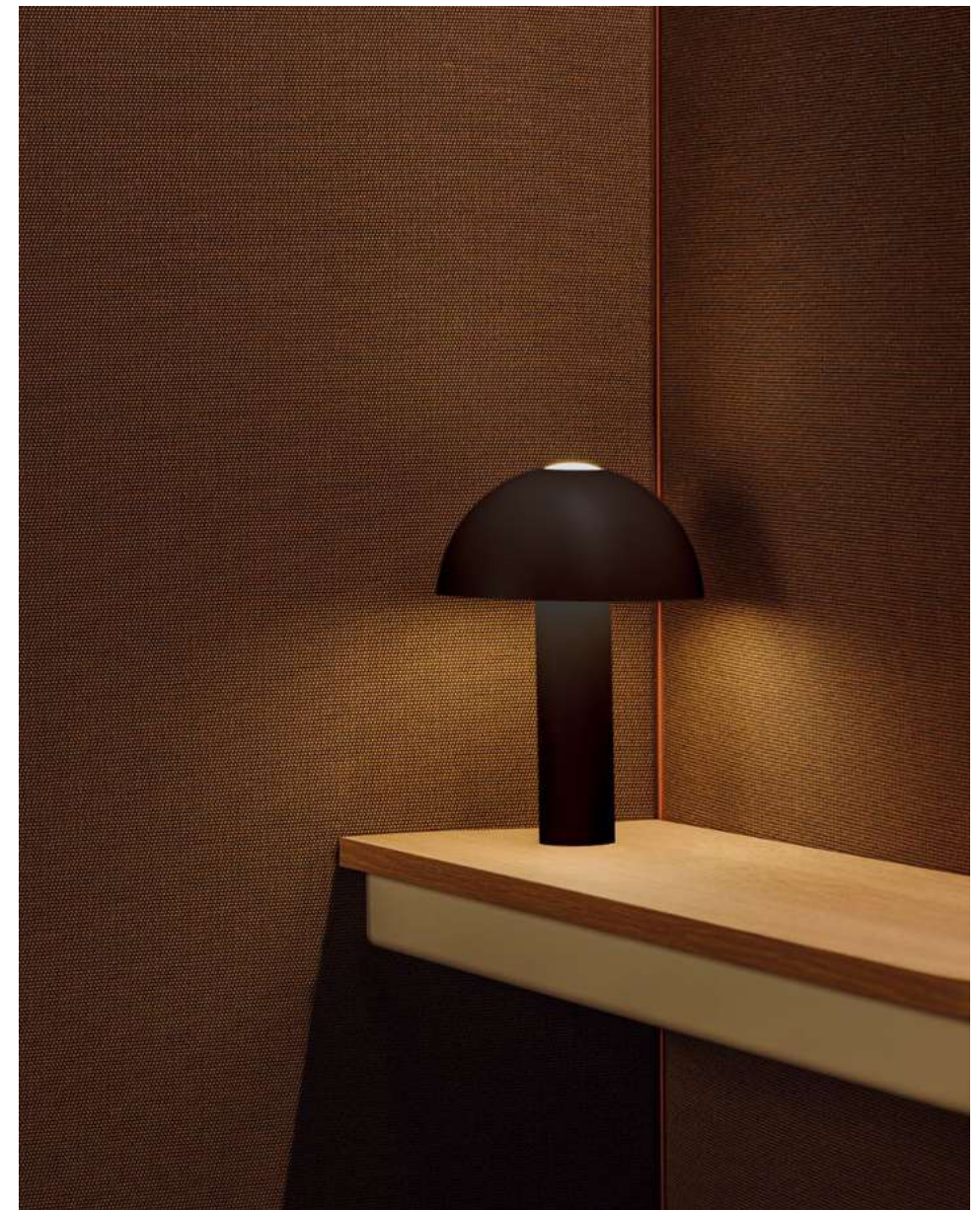

(only on demand)

Tracks system

Integrated



LED track curtain Integrated



LED track integrated



LED track slats integrated

Pendant / Wall Curtain



LED track



LED track curtain

Dots system

Ceiling



Dots pendant (open / close)



Dots articulated



Integrated microdots

Integrated



Dots light up



Dots light down



Table Dots lam
(Phonebooths only)

Technical specifications

Since the introduction of computers, office structures and work habits have never undergone such a radical transformation as the one we are currently experiencing. Thanks to communication technology, offices are becoming public spaces. Many companies create open-plan and inspiring places in which employees and visitors can relax, hold meetings or spend the day working. The daily use of laptops, smartphones and tablets has given rise to new patterns of behavior that are now also observed in offices. Home automation, audiovisual media, network connections and booking rooms are necessary resources for day-to-day work in the office.

Unlock extra workspace potential with cutting edge technology.

Management System

Description

A smart technology fully integrated. It's a fully integrated business space solutions that streamline workflows and resource management for smarter, more efficient workplaces. We work with the platforms that enables you to perform all your daily activities (calls, presentations, collaboration) in every one of your workspaces and manage them securely online.

Key funtions

- Audiovisual hardware
- Mirroring
- Videocalls
- Booking

Partners

LUTRON

CRESTRON

SAMSUNG

JUNG

Personal



Touch Screen



Smartphone



Tablet

The Pavilion system allows 4 project layers depending on what the client prefers:

	Stand Alone	Hub Basic	Hub Server Pro	Hub Bacnet
Control from pres- ence sensor and push buttons	✓	✓	✓	✓
Control / Dimming from app and mobile device	✗	✓	✓	✓
Status / Occupation	✗	✓ <small>(information instantly)</small>	✓	✓
Location map Statis / Occupation	✗	✗	✓	✓
Usage hours	✗	✓ <small>(information instantly)</small>	✓	✓
Air renewal control	✗ **	✓ **	✓	✓
Room booking with schedule	✗	✗	✗ **	✓
Notification 10 minutes before the end of the reservation	✗	✗	✗	✓
Equipment failure warning	✗	✓	✓	✓
Sensor CO ₂ Bacnet	✗	✗	✗	✓
Warranty	2 years	5 years	5 years	5 years
Remote support	✗	✓	✓	✓
Scenes & schedules programming	✗	✓	✓	✓

Extra information:

*In case of not selecting any Hub option, all the material only has a 2-year warranty.

*In case of not selecting any Hub option, we cannot offer remote support.

**Can't be done through the ROS System but can be managed from most of the third part accesory booking screen.

Monitor & audiovisuals

Monitor key funtions

- Slim video monitor
- Plug & Play system
- 3 different Sizes
- Samsung monitor

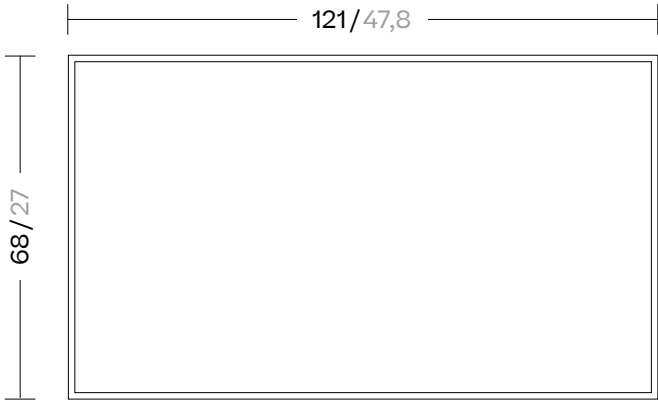

Cm/Inches

Key Features

- Secure
- Can be managed remotely
- Fast connection
- Data connection between Wireless
- Mirroring

Crestron bar

- 4K camara with 150° viewing
- Surrounding audiosystem
- Full set of configurable

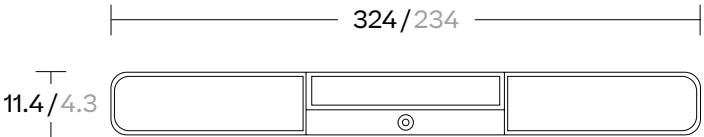

Cm/Inches



Kode screen

Key funtions

- Intuitive Touchscreen Control: Kern features an intuitive touchscreen interface that simplifies the control of various office functions.
- Lighting Control: Effortlessly manage lighting within your office space, adjusting brightness and ambiance to suit different tasks and preferences.
- Scene Customization: Create and save custom scenes to set the perfect mood or functionality for meetings, presentations, or everyday work.
- Ventilation Management: Take charge of indoor air quality and comfort by controlling the ventilation system, ensuring a conducive working environment.



Safety

Key funtions

- Smoke detection
- Sprinklers



Smoke detector



Sprinklers



Air ventilation

Key funtions

- Silent air circulation system
- Intelligent monitoring through C02, humidity and temperature sensors (optional)
- Equipment has particle filtration and microorganism elimination by germicidal ultraviolet light (optional)
- Climate building system compatibility
- Prefilter M5 (65% efficiency 0,3 micron particules
- Absolute HEPA Filter (99,97% efficiency on 0,3 micron particules. (optional)
- CPZ filter for gas and odor removal (activated Carbon, Potassium Permanganate and Zeolite, efficiency greater than 90%) (optional)

Sensor for C02 & humidity

Ocupacy	Units	Qm3 (min/max)
Up to 4 people	1	175/700 m3
Up to 12 people	2	350 - 1400 m3

Air extractor

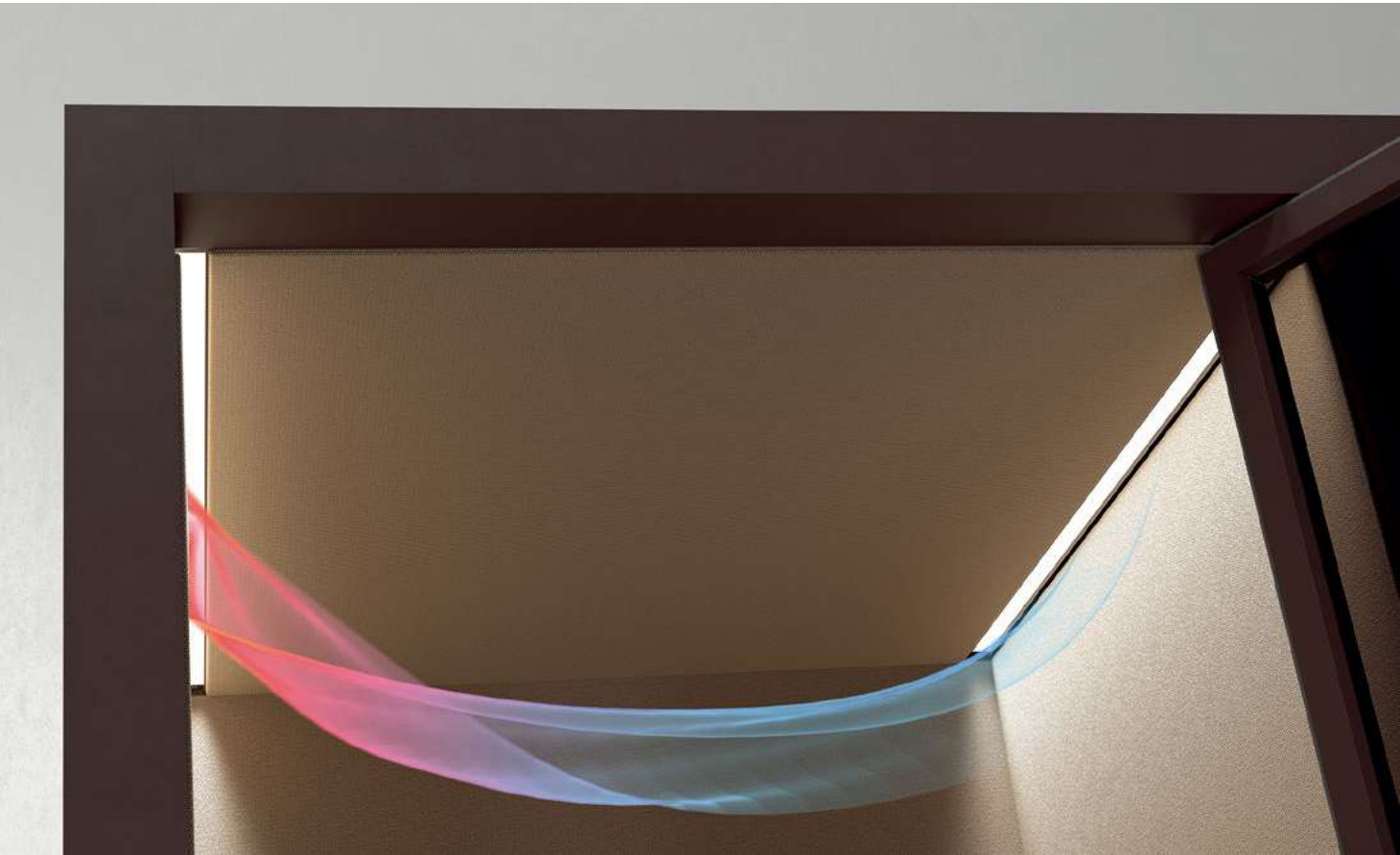

Room Flow air conditioning

Connection

Description

The electrical system within the Pavilion O is designed to be discreet, elegant and practical. Embedded in the structure, it is easily accessible and is thought within the design.



Control center



Socket End points



Pavilion connection point

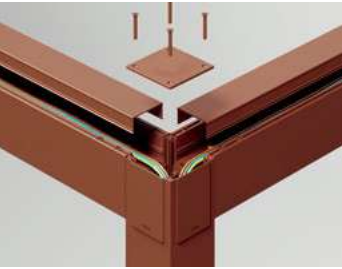

Easy access in-wall wiring

Wall mounted outlets

Key funtions

- Data Port
- HDMI
- Power Outlet
- USB
- Configurable
- Shatter-proof
- Flat design line

7,4/2,91

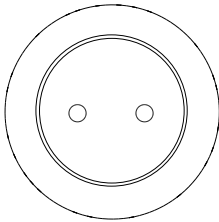

Cm/Inches



Table/Column mounted outlets

Hardware

- Simple design
- Power Connections
- USB
- Plug and outlet types (UK, FRA, US, SUI, AUS,...)

10,2/4,01

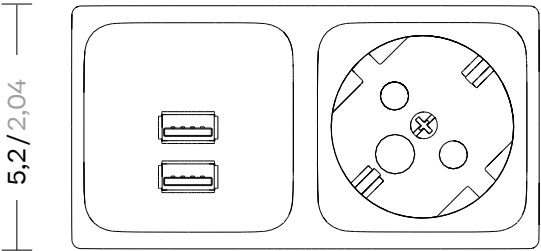

5,2/2,04

Cm/Inches



Acoustic side panels

44 db

Description	Key funtions
<p>All our panels are tested to ensure they meet the required acoustic levels. We have tested some of the wall combinations to provide guidelines with regard to acoustic levels. Acoustic performance varies depending on the material selection for each wall.</p> <p>The O glass version offers excellent acoustic performance, creating a comfortable and efficient working environment. It is based on 3+3 and 6+6 laminates with a soundproofing membrane to provide an impressive acoustic performance of up to 44dB. We also offer a range of solid wall options in fabric and wood. Many of these alternative wall options offer excellent acoustic performance properties. Our laminated panels not only provide additional acoustic performance, but also come in a range of colors. As a result, you can customize your Pavilion O to reflect your brand image or simply to create a bright office space. In addition, the eco-friendly panels reduce and control reverberated noise within the Pavilion, further enhancing the overall soundproofing performance.</p>	<ul style="list-style-type: none">• Fire retardant M1• Memory acoustic foam• Easy clean material• Odor free and antimicrobial

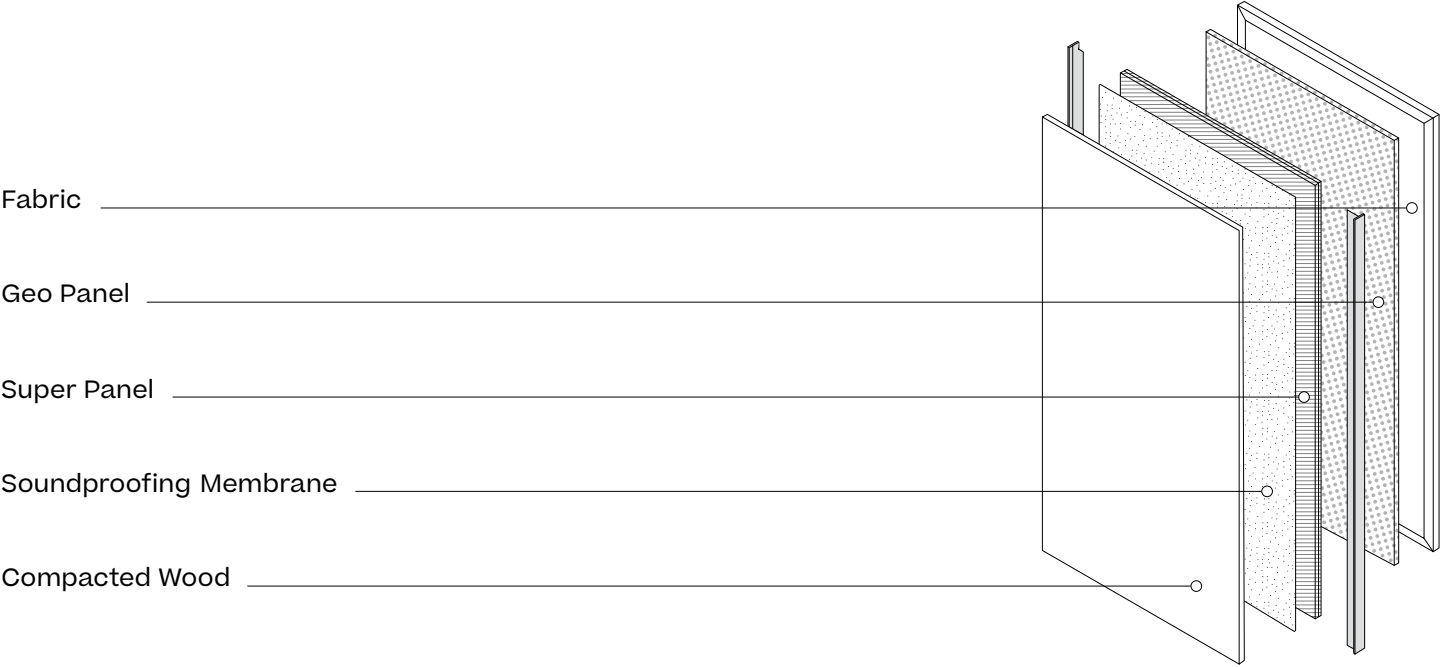

Acoustic Panel Comfort (36 db)			
Interior		Exterior	
Geo Panel 30mm, 50 Kg/m3			Geo Panel 30mm, 50 Kg/m3
Geo Panel 10mm, 704 Kg/m3			Super Panel 10mm 704 Kg/m3
Super Panel 10mm 704 Kg/m3			Fabric
Fabric			
Acoustic Panel Plus (44 db)			
Interior		Exterior	
Geo Panel 30mm, 50 Kg/m3			Geo Panel 30mm, 50 Kg/m3
Geo Panel 10mm, 704 Kg/m3			Soundproofing Membrane, 5'3mm, 10kg/m2
Super Panel 10mm 704 Kg/m3			Soundproofing Membrane, 3'7mm, 7kg/m2
Fabric			Super Panel 10mm 704 Kg/m3
			Fabric



Ceiling Panel

32 dBa

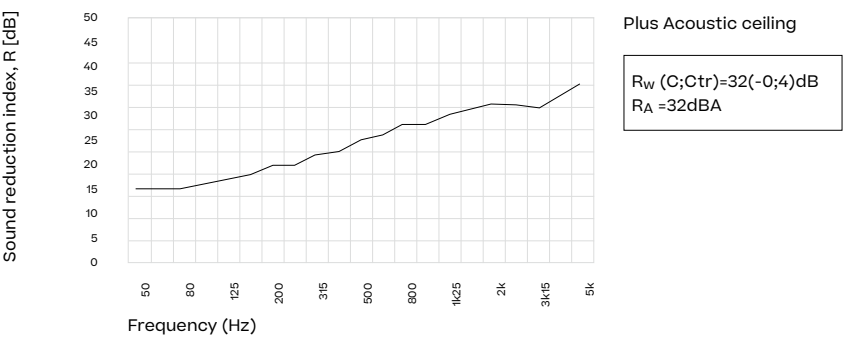

Acoustic Side Panel

Comfort Plus
36/44 dBa

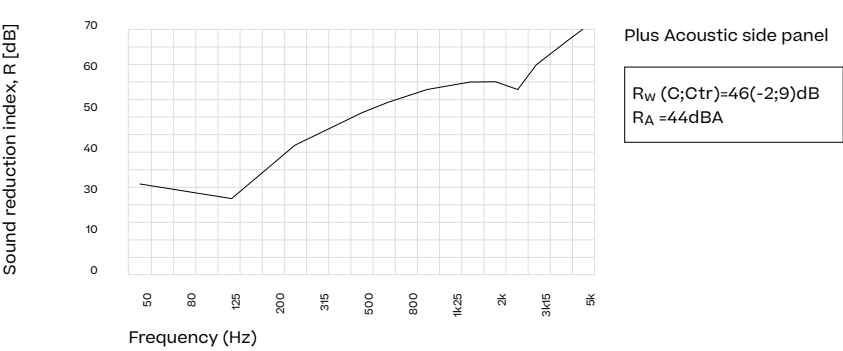

Acoustic Glass & Glass Door

Comfort Plus
35/40 dBa

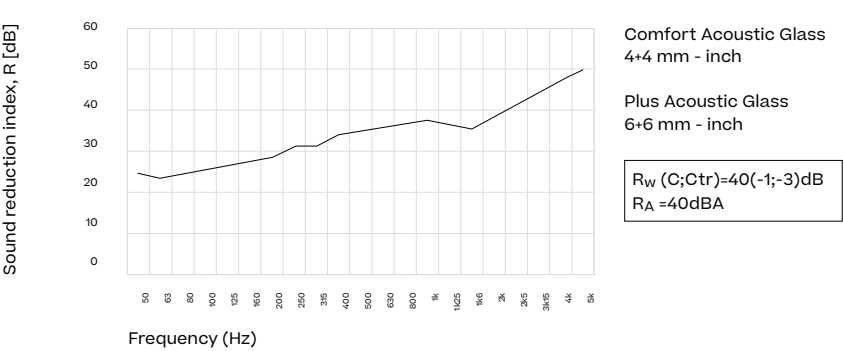

Average reverberation

0,2 RT

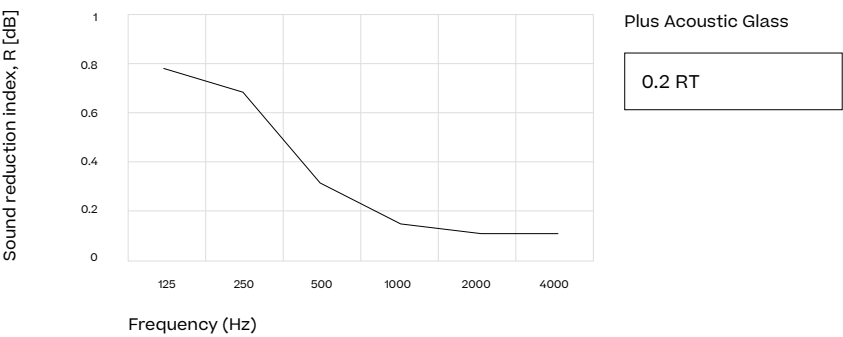

Materials

The materials in the new collection of the Pavilion O system are represented by fabrics, metals, woods, stones and ceramics. All of these worlds form the basis of the library. The intention is to inspire and invite the professional to explore and combine colors, textures and materials to create new exclusive codes for each project and each use.

Recyclable and exclusive materials, to explore an infinite number of combinations.

Workplace

Base (Eolias indoor & A only)



Rice Cake
F01



Toasted Almond
F02



Pecan Pie
F04



Indian Sunset
F05



Stardew
F09



Orion Grey
F10

Leather (Eolias indoor & A only)



Tumbleweed
362



Kobicha
363

Relate Fabrics (O Pavilion & collection)



V07



V04



V02



V09



V10



V12



V13



V17



V18



V20



V06



V25



V31



V32



Fire retardant

Material

Nuvola (Pavilion O)



Andina Grey
PF1



Ibizenca Sand
PF2



Hickory Brown
PF3



Baja Dunes
PF4



Iron Ore
PF5



Clary Sage
PF6

Maya (curtains)

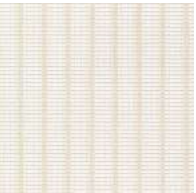

Bonneville
K06

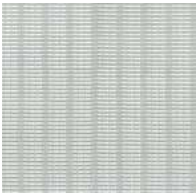

Nevada
K03

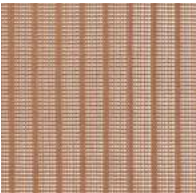

Colorado
K08

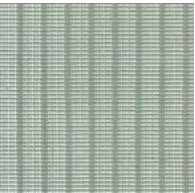

Black Sea
K12

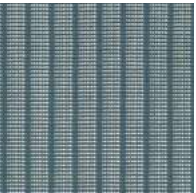



Veldt
K11



Fire retardant



Terrain Paint

								
Slate Stone 01C	Mysty Smoke 02C	Ash 03C	Bone 04C	Tuff 05C	Wet Stone 06C	Sand Dune 07C	Dry Clay 08C	Arabica 09C
								
African Savannah 010C	Desert Storm 011C	Ginger Root 012C	Amber 013C	Terracota 014C	Terrarosa 015C	Rose Canyon 016C	Sunset Glow 017C	Ruby Dust 018C
								
Sepia 019C	Blossom 020C	Wild Lupin 021C	Indigo 022C	Nightfall 023C	Polar Sky 024C	Glacier Ice 025C	Sea Moss 026C	Forest Stream 027C
							Terrain Lustre (Eolias only)	
Spring Meadow 028C	Komby 029C	Bronze 030C	Corten 031C	Manganese 032C	Galena 033C	Noir d'Ivoire CH2		

Ceramics

			
Ceppo di Gre	Du Gent Grey	Neutral Caliza	Royal Black

Glass Paints

			
Tuff 05C	Sand Dune 07C	Rose Canyon 16C	Dry Clay 08C
			
African Savannah 10C	Sea Moss 26C	Indigo 22C	Ash 03C



Wood (A collection)



Natural Oak
(table)

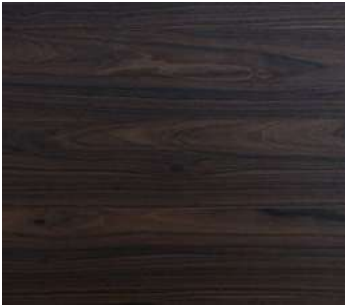

Burnt Oak
(table)



Natural Ash
(chair)

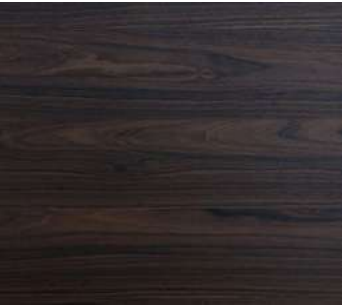

Burnt Ash
(chair)

Compact Wood (Kall & Pavilion O only)



Light Oak
CW1



Dark Oak
CW2

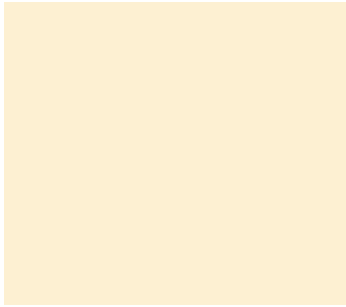

Soft Beige
LW1



Soft Cream
LW2



Light Brown
LW3

Standards:
- EN 14323
- EN 438-2
- ISO 22196

Sustainability: Building a greener tomorrow.

At Kettal, we are committed to more than just creating exquisite outdoor furniture and designs. We are dedicated to shaping a sustainable future where beauty and nature coexist harmoniously. Our journey towards sustainability is rooted in a deep respect for the environment and a passion for innovation.

In an era where the preservation of our planet is of utmost importance, Kettal is taking meaningful steps towards reducing our carbon footprint, conserving natural resources, and minimizing waste. Our sustainable practices extend from the selection of eco-

friendly materials to energy-efficient manufacturing processes, all while maintaining our unwavering commitment to craftsmanship and design excellence.

Join us in exploring the world of Kettal Sustainability, where style meets eco-consciousness. Discover how we blend creativity with responsibility, striving to inspire a lifestyle that not only enhances outdoor spaces but also safeguards the planet for generations to come. Together, we can forge a greener tomorrow, one design at a time.

We monitor the life cycle of our products.

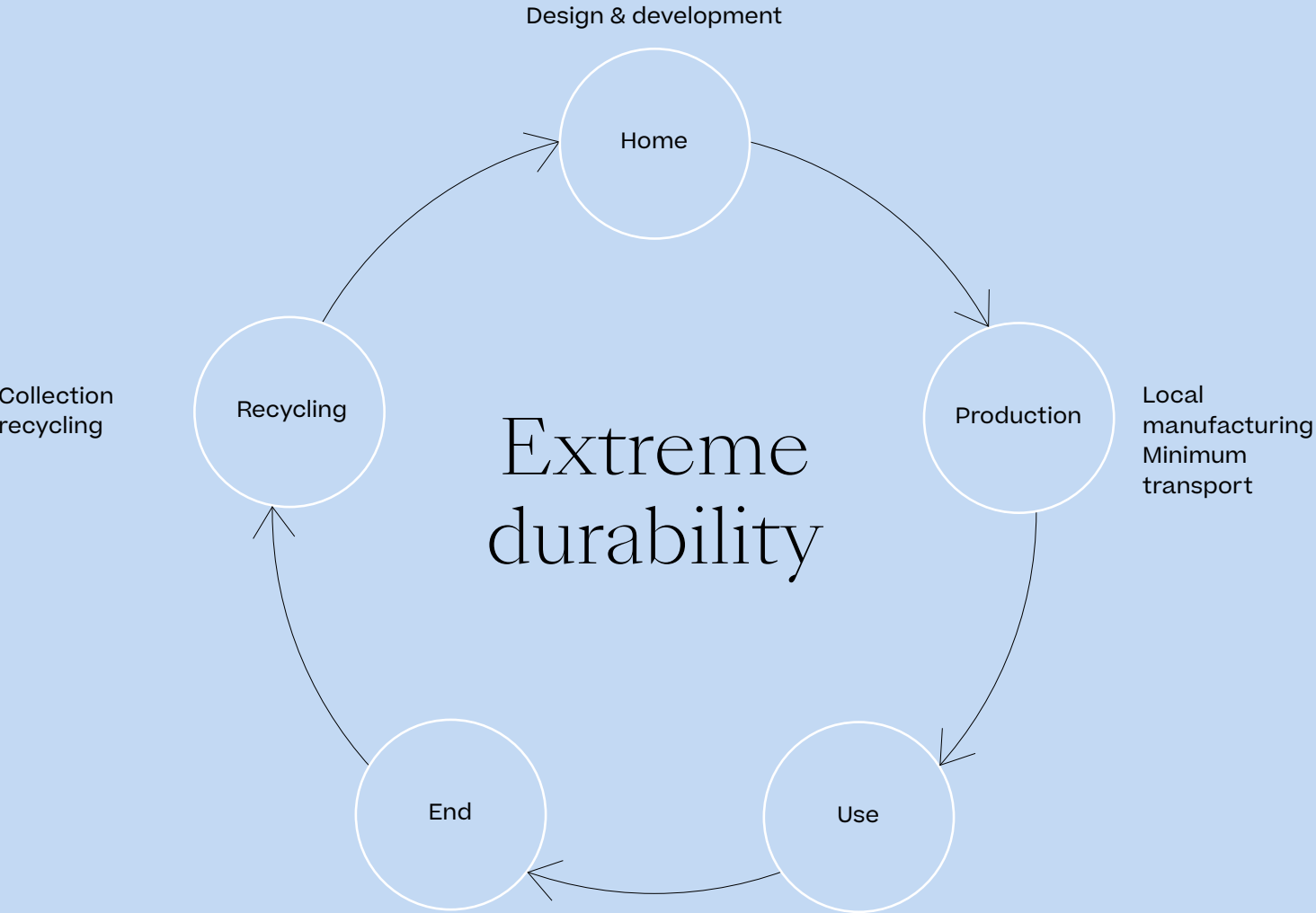

Environmental aspects

Nearly 100% of paint used is recyclable and eco-friendly.

The most significant environmental aspects in the furniture sector are related to the consumption of raw materials, specifically fuel, paint and wood used in furniture manufacturing. With this in mind, we implement continuous measures to minimise any negative impacts on the environment. For example, Kettal carries out product research to improve processes and assess the possible external impact of its products.

True to its philosophy of respect for the environment, Kettal ensures that its main materials, such as paint and wood, are both high-quality and environmentally sustainable. As a result, almost 100% of the paint it uses is recyclable and environmentally friendly. Its main supplier of paint used in the manufacture of furniture has both quality certifications (Qualicoat, GSB, IKS, Quali Steel Coat) and environmental certifications for its products (verified by AENOR in accordance with its Global EPD type III ecolabel system, ISO standards, etc.).

As regards wood, Kettal uses teak certified by the agency SUCOFINDO, which guarantees environmental requirements, commitment to quality, occupational health and safety and social responsibility. Likewise, following its commitment to offer the best design and the highest product quality, for each new design it draws up an Environmental Product Declaration (EPD) for the purpose of assessing the



environmental impacts. The study for the EPD produces quantitative information on the product’s environmental performance through all stages of its life cycle. This information is relevant when identifying sources of environmental impact, prioritising, making decisions focused on minimising the environmental impacts of similar or future products, implementing eco-design strategies and providing consumers with environmental product information.

Given the characteristics of the sectors in which Kettal operates, it does not use any materials or production processes that directly release greenhouse gases (GHGs) or other substances with a serious environmental impact.

Products

Our products are local manufactured and 85% handmade.

The human factor is crucial as manual processes take priority over mechanical ones. This allows using techniques that would not be possible in a standard production line process and meticulous control over the quality.

Kettal has analyzed the variants of product life cycle to minimize environmental impact as far as possible. Not only in our raw material usage, but also other variables such as CO2 emissions from transport or use and durability. Under this premise, the raw materials are recyclable and/or recycled, and the objective is to produce all components close to the production site. For example, the essential raw material used at Kettal, such as fabric, rope, and aluminium, are produced within a radius of 100km. Also, each design is aesthetically designed and technically developed to last as long as possible, that is why Kettal keeps technical drawings and product patterns that are 30 years old in order to be able to replace components and extend the life of the product.

Our mission is to create furniture that is timeless and contemporary, combining creativity, personality, innovation, and modern production methods. We praise the simplicity and beauty of everyday life, the excellence in our production and customer service. We believe in sustainable growth through building lasting relationships and products.

When it comes to our products, sustainability is at the core of our design and manufacturing processes. We carefully select materials that are ethically sourced and environmentally friendly, ensuring they meet our high standards for quality and durability. We embrace innovative technologies and techniques that reduce waste, energy consumption, and carbon footprint throughout the production cycle.

Additionally, our commitment to sustainability extends to our supply chain. We work closely with our suppliers to ensure they adhere to responsible and sustainable practices. By promoting fair labor conditions, minimizing environmental pollution, and supporting local communities, we strive to create a positive impact beyond our own operations in Bellvei, a small coastal village 45km from Barcelona.



Materials

Materials are an important part of caring for the environment and a key factor in the product life cycle. All materials are recyclable and recycled as much as possible, as long as they have the characteristics to ensure durability. The better the quality, the longer the product life cycle. And a longer life cycle means it is more environmentally friendly, as fewer manufacturing processes will have to be put in place, reducing the carbon footprint and generating less waste.

Our raw materials are not only recyclable, but recycled. We study the impact of the material recovery process and the durability of the material over time. The essential raw materials are produced locally, within a radius of 100km. We have analysed each product life cycle to minimize environmental impact as far as possible. Not only raw materials, but other variables such as CO² emissions from transport or use and durability.

Materials			
Aluminium	<div><div></div></div> 85% Recycled	<div><div></div></div> 100% recyclable	Carbon emissons: 6,99kg CO2 eq/kg Durability average: 30 years
Terrain Coatings	<div><div></div></div> 0% Recycled	<div><div></div></div> 0% recyclable	Carbon emissions: 0,88 kg co2 eq/kg Durability average: 20 years
Relate fabrics	<div><div></div></div> 10% Recycled	<div><div></div></div> 100% recyclable	Carbon emissions: 0,321 kg co2 eq/kg Durability average: 15 years
Glass	<div><div></div></div> 20% Recycled	<div><div></div></div> 100% recyclable	Carbon emissions: 0,79 kg co2 eq/kg Durability average: 30 years
Stainless Steel	<div><div></div></div> 70% Recycled	<div><div></div></div> 100% recyclable	Carbon emissions: 4,55 kg co2 eq/kg Durability average: 20 years
Bela Ropes and Stripes	<div><div></div></div> 50% Recycled	<div><div></div></div> 100% recyclable	Carbon emissions: 2,21 kg co2 eq/kg Durability average: 15 years
Terrain Elements Fabrics	<div><div></div></div> 10% Recycled	<div><div></div></div> 100% recyclable	Carbon emissions: 3,81kg co2 eq/kg Durability average: 15 years
Parallel	<div><div></div></div> 60% Recycled	<div><div></div></div> 100% recyclable	Carbon emissions: 2,72 kg co2 eq/kg Durability average: 20 years
Ceramic	<div><div></div></div> 0% Recycled	<div><div></div></div> 85% recyclable	Carbon emissions: 0,67 kg co2 eq/kg Durability average: 30 years

Key values

We do not build in obsolescence.

Fluorocarbon-free Fabrics

Creation of Terrain Fabrics, first fabric finished with a fluorocarbon-free compound, which is the ideal way to achieve wearing comfort and protect the material in an environmentally friendly way. Since then, all our fabrics are fuorocarbon-free.

FSC Wood

All wood used in our furniture is FSC certified, ensuring its sustainable origin and responsible management. The wood used in our furniture has been sourced from well-managed forests, supporting the conservation of natural habitats and the livelihoods of local communities.

Goal: Zero emissions

At Kettal, our goal is to achieve zero emissions by 2036. We are committed to minimizing our environmental impact and actively working towards a sustainable future. Through innovative practices, energy-efficient technologies, and responsible manufacturing processes, we aim to eliminate greenhouse gas emissions from our operations entirely. We understand the urgency of addressing climate change, and reaching this ambitious target is an essential step in creating a better world for future generations.

Pavilions

Our Pavilions are made with 85% Recycled materials.

Carbon footprint

Since the past year, we have been analyzing the carbon footprint of each of our products. In our commitment to sustainability, we believe it is essential to understand and reduce the environmental impact of our manufacturing processes. By examining the carbon footprint, we aim to identify areas where improvements can be made, such as optimizing energy consumption, reducing emissions, and implementing eco-friendly materials. This ongoing analysis allows us to make informed decisions and work towards creating more environmentally-conscious products for our customers.

Environmental-certified materials

Our materials are backed by environmental certifications. These certifications ensure that the materials we use in our products have been sourced and processed in an eco-friendly and sustainable manner. We are committed to upholding these environmental standards and continuously seeking ways to minimize our ecological footprint.

CFC-free polyurethane

The polyurethane we use is CFC-free. CFC stands for chlorofluorocarbon, which is a harmful substance known for its ozone-depleting properties. By opting for CFC-free polyurethane, we ensure that our products contribute to a healthier planet by reducing the release of harmful substances into the atmosphere. We believe in creating sustainable and responsible designs, and this commitment extends to the materials we choose.

Paint almost 100% recyclable

Almost 100% of the paint we use is recyclable and environmentally friendly. The main supplier of paint used in the manufacture of furniture has both quality certifications (Qualicoat, GSB, IKS, Quali Steel Coat) and environmental certifications for its products (verified by AENOR in accordance with its Global EPD type III ecolabel system, ISO standards, etc.).

We care about our employee's security and wellbeing.

- Strict Workplace Security and Protection norms and continuous Workplace Risk Assessment and Training.
- Internal career promotion enhancement giving priority to fill an open role with an existing employee instead of hiring someone new.
- Improve work-life balance with flexible work hour schedules.



We promote diversity and inclusion within our employees.

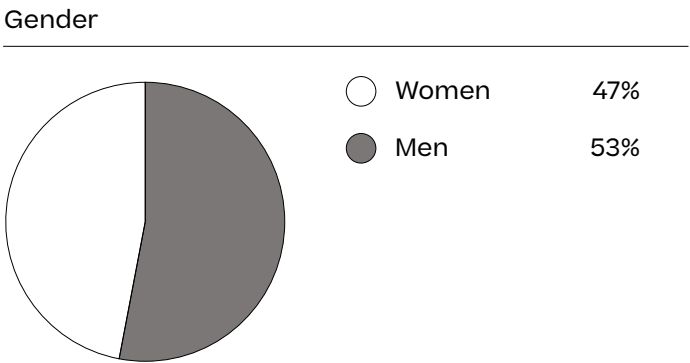

- Advocate for the people to maintain pay equality.
- Equal pay policy between genders implementing fair scheduling practices.
- Recruitment policy does promote gender equality and multi-cultural inclusion.
- Application of Spanish Family leave and childcare policies.
- Acknowledgement of holidays for all cultures.
- Promotion of team working across the organization.

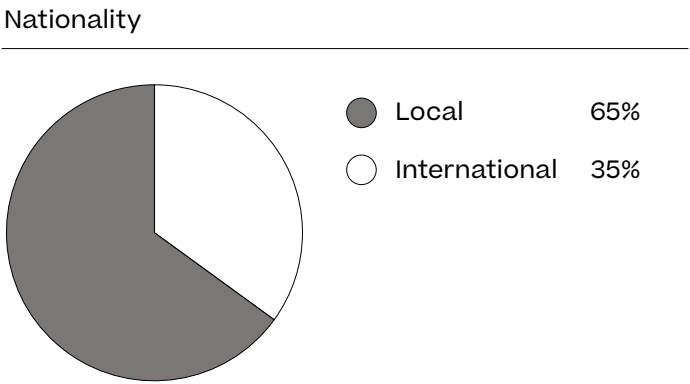

Statistics	Kettal	Industry
Staff Turnover	7	17,1
Work Absenteeism (%)	2,21	6,16
Seniority Average (yr)	19,26	10,26
Accident Frequency	0,02	26,4

Our average period of employment is 19,26 years.

We would love to hear from you.

Head office

Kettal Barcelona
Aragón, 316
08009 Barcelona, Spain
T. (34) 93 487 90 90
F. (34) 93 487 90 66



Download our
Living catalogue



Download our
Contract catalogue



See the finishes of
each photo

Showrooms

Kettal Barcelona
Aragón, 316
08009 Barcelona, Spain
t. (34) 93 488 10 80
tienda.bcn@kettal.es

Paris Showroom
80, Blvd Malesherbes
75008 Paris, France
t. (33) 1 43 59 51 40
boutique.paris@kettal.es

Miami Showroom
147 Miracle Mile
Coral Gables,
Florida 33134, USA
t. (1) 786 552 90 22
miami.store@kettal.es

Marbella Showroom
Crtra. de Cádiz, Km.179
(entre el Marbella Club
y el Guadalpin)
29600 Marbella, Spain
t. (34) 95 277 89 89
tienda.marbella@kettal.es

London Showroom
15-16 Dufferin St,
London EC1Y 8UR, Reino Unido
t. +44 7507 717891

New York
The D&D Annex:
222 East 59th Street
Suite 222-333
New York, NY 10022, USA
t. (1) 917-992-9419
newyork.showroom@kettal.com

Chicago
The Mart.
222 Merchandise Mart Plaza,
Suite 10-155
Chicago, IL 60654 USA.
T. 312.244.0527
chicago.showroom@kettal.es

Melbourne Showroom
510 Church Street Melbourne
Richmond VIC 3121, Australia
t. (03) 9957 8799